

BJ153

TAPPED TAPER-NOSE STRAPS

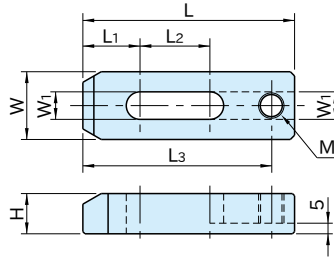

Body
Steel (S45C)
Quenched and tempered
Black oxide finish

Part Number	L	W	H	W ₁	L ₂	M	L ₁	L ₃	Clamping Force (kN) Pad Protrusion Max. - Min.	Allowable Screw Torque (N·m)	Weight (g)	
BJ153-08040	40	19	12	9	6	M 8×1.25	10	32	5.3~ 7.3	17	50	
BJ153-08050	50				14		42	4 ~ 7.6	60			
BJ153-08063	63				27		55	3.1~ 8.3	70			
BJ153-10050	50	25	12	11	8	M10×1.5	12	40	8.5~11.9	34	80	
BJ153-10063	63				18		53	6.4~12.2	100			
BJ153-10080	80				32		70	7.4~17.7	170			
BJ153-10100	100	16	16	40	40	M12×1.75	15	90	8.8~18.8	45	220	
BJ153-10125	125				50		115	9.8~19.6	280			
BJ153-12063	63				14		52	13.7~21.6	190			
BJ153-12080	80	32	16	25	14	M12×1.75	20	69	10.3~21	71	240	
BJ153-12100	100				40		89	10.9~25.8	350			
BJ153-12125	125				50		114	12.9~27.5	440			
BJ153-12160	160	19	13	60	40	M12×1.75	20	149	15.4~28.8	80	570	
BJ153-16080	80				17		18	65	16.6~26		115	320
BJ153-16100	100				30		25	85	14.2~28.4		129	540
BJ153-16125	125	45	25	110	14.7~31.1	670						
BJ153-16160	160	65	25	145	15.3~33.4	850						
BJ153-20160	160	50	25	60	M20×2.5	32	144	16.5~35.6	183	1140		
BJ153-20200	200			80			184	17.9~37.8		1440		

How To Use

