

# BJ530

# HOOK-CLAMP HOLDERS

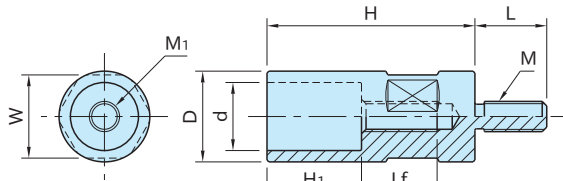

- BJ530-04
- BJ530-08
- BJ530-10
- BJ530-06
- BJ530-12
- BJ530-16

Body
S45C steel
Black oxide finish

Part Number	H	D	d*)	H <sub>1</sub>	M <sub>1</sub>	L <sub>f</sub>	M	L	W	Allowable Screw Torque(N·m)	Weight (g)
BJ530-04035	35	14	10	16	M 4×0.7	13	M 6×1	11	12	2.7	30
BJ530-06040	40	16	12	19	M 6×1	14	M 8×1.25	14	13	7	45
BJ530-08055	55	24	18	25	M 8×1.25	20	M 8×1.25	19	22	30	140
BJ530-10063	63	32	20	30	M10×1.5	21	M12×1.75	30	30	38 (32**)	400
BJ530-10080	80					23					500
BJ530-12080	80	40	25	40	M12×1.75	25	M12×1.75	30	36	50 (46***)	600
BJ530-12100	100										800
BJ530-16080	80	50	32	40	M16×2	25	M16×2	30	46	80	930
BJ530-16100	100										1230

\*) Tolerances of d Diameter

BJ530-04 | BJ530-06 :  $^{+0.1}$

BJ530-08 | BJ530-10 | BJ530-12 | BJ530-16 : F7

\*\*\*) The value to use with BJ130-10040.

\*\*\*\*) The value to use with BJ130-12060 or BJ130-12160.

### Note

The above screw torque values are effective for installation of BJ130 | BJ132 Hook Clamps.

### How To Use

