

BJ760

SCREW REST PADS

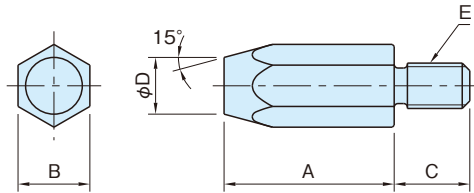

Material & Finish

Steel (S45C)
 Quenched and tempered
 Black oxide finish
 Heat treated to Rc33-39

Part Number	A	B	C	D	E	Weight (g)
BJ760-06001	10	10	11	8	M 6×1	6
BJ760-06002	20			6		13
BJ760-08001	15	13	13	10	M 8×1.25	18
BJ760-08002	30			9		33
BJ760-10001	20	17	16	13	M10×1.5	44
BJ760-10002	40					80
BJ760-12001	25	19	20	15	M12×1.75	70
BJ760-12002	50					120