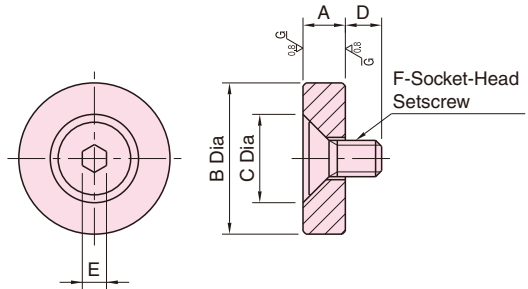

BJ763**FLAT FEET**

[Body]

Material : S45C steel

Heat Treat : Quenched and tempered

Finish : Black oxide

Precision ground

Part Number	A ($\begin{smallmatrix} +0.01 \\ 0 \end{smallmatrix}$)	B	C	D	E	F	Weight (g)
BJ763-06001	5	25	14	7.7	4	M6x1	20
BJ763-06002		30					30
BJ763-06003		35					40
BJ763-06004	10	25	10.7	4	M6x1	40	
BJ763-06005		30				60	
BJ763-06006		35				80	
BJ763-08001	10	30	19.4	11.3	5	M8x1.25	60
BJ763-08002		35					80
BJ763-08003		40					100
BJ763-08004	15	30	11.3	5	M8x1.25	90	
BJ763-08005		35				115	
BJ763-08006		40				150	

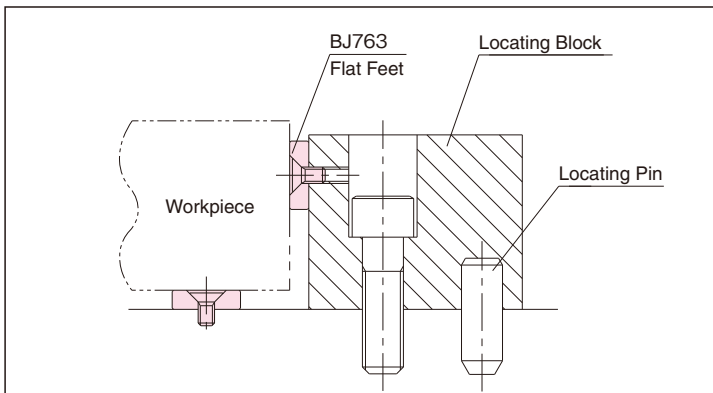
How To Use

Use to support and locate a workpiece. The accuracy of a locating block can be easily compensated by regrinding the top surface of Flat Feet.