

CP155-L

TAPERED CLAMPING SCREWS (Round)

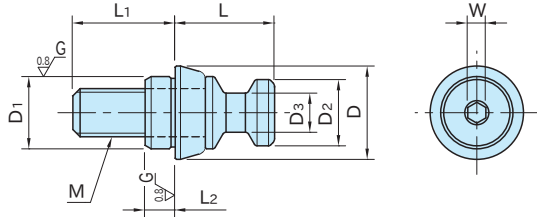

Tapered Bushing	Clamping Screw
S45C steel Black oxide finished Precision ground	SCM435 steel Quenched and tempered Black oxide finished

Part Number	M	D ₁ (g6)	L ₂	L ₁	D	L	D ₂	D ₃	W	Weight (g)
CP155-08001L	M 8×1.25	12	5	17	15.5	16.5	11	6.5	3	20
CP155-12001L	M12×1.75	18	6	24	24.5	25	16	9.5	5	70
CP155-16001L	M16×2	22	7.5	30	31.5	33	21	13	6	150

CP155-D

TAPERED CLAMPING SCREWS (Diamond)

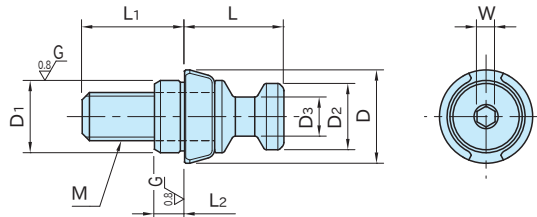

Tapered Bushing	Clamping Screw
S45C steel Black oxide finished Precision ground	SCM435 steel Quenched and tempered Black oxide finished

Part Number	M	D ₁ (g6)	L ₂	L ₁	D	L	D ₂	D ₃	W	Weight (g)
CP155-08001D	M 8×1.25	12	5	17	15.5	16.5	11	6.5	3	20
CP155-12001D	M12×1.75	18	6	24	24.5	25	16	9.5	5	70
CP155-16001D	M16×2	22	7.5	30	31.5	33	21	13	6	150

How To Use

Round Type

- Can be used for locating a **CP151** Clamping Module (Double).
- Can be used for locating a workpiece with diamond type.

Diamond Type

- Can be used for locating a workpiece with round type.
- Fix the tapered bushing of diamond type after deciding the direction.

Mounting-Hole Dimensions

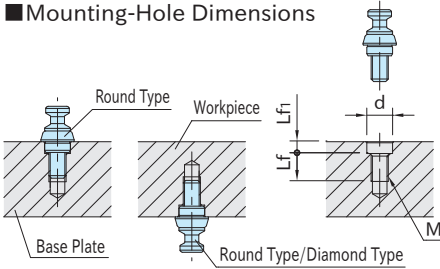

Part Number	d (H7)	Lf	Lf1	M
CP155-08001D	12	13	5.5	M 8×1.25
CP155-12001D	18	19	6.5	M12×1.75
CP155-16001D	22	23	8	M16×2

Application Example

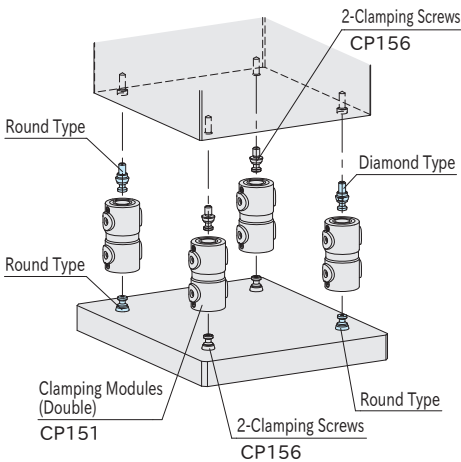

Spacing Tolerance

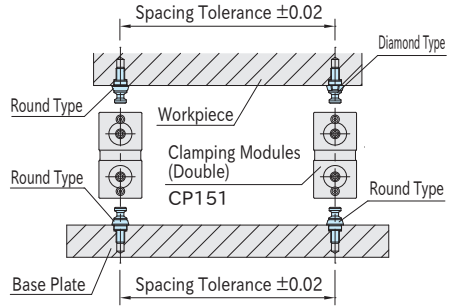

Coupling of Clamping Module (Single)

Round type can be used as a coupling for Clamping Module (Single).

〈Locating Repeatability is 8 μm〉

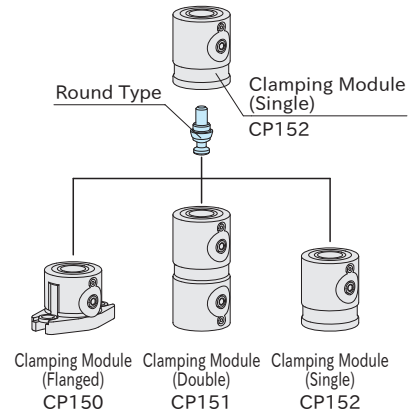

Related Products

- **CP150** Clamping Modules (Flanged)
- **CP151** Clamping Modules (Double)
- **CP152** Clamping Modules (Single)
- **CP156** Clamping Screws