

CP731

ONE-TOUCH FLEX LOCATOR CLAMPERS (Cam Handle)



CP731-LC
(Tapered)

CP731-SC
(Straight)

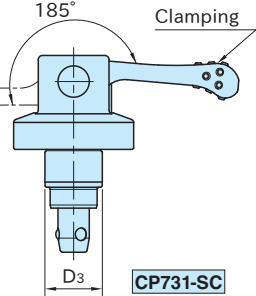
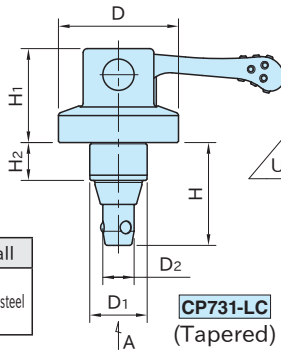
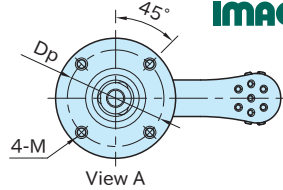
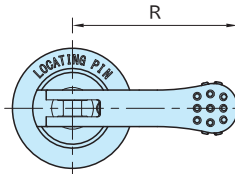

CP731-LC
(Tapered)

CP731-SC
(Straight)

Body	Cam Handle	Ball
SCM440 steel ISONITE Treated (Nitrocarburized)	SCM440 steel Black oxide finished Quenched & tempered	SUJ2 steel

Part Number	D ₁ (g6)	D ₃ (-0.06 -0.06)	H ₂	D	H ₁	D ₂	H	M	D _p	R	Cam Handle
CP731-0939LC	18	—	9.5	39	30	9	30	M4x0.7 Depth 6	30	50	QLCA-05
CP731-0939SC	—	18									
CP731-1246LC	22	—	14.5	46	36	12	40		37	63	QLCA-06
CP731-1246SC	—	22									
CP731-1656LC	28	—	19.5	56	42	16	51		45	80	QLCA-08
CP731-1656SC	—	28									

Part Number	Clamping Force (N)	Operating Load (N)	Weight (g)	Proper Bushing
CP731-0939LC	600	60	191	CP735-0939L
CP731-0939SC			189	CP735-0939S
CP731-1246LC	1200	130	297	CP735-1246L
CP731-1246SC			294	CP735-1246S
CP731-1656LC	1800	160	654	CP735-1656L
CP731-1656SC			648	CP735-1656S

How To Use

■ Mounting Hole Dimension

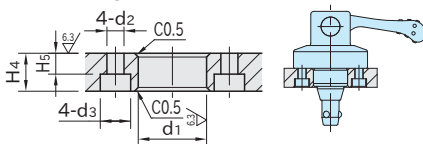

Size	d ₁ (H7)	H ₄ (±0.05)	d ₂	H ₅	d ₃
CP731-0939	18	10	4.5	5	8
CP731-1246	22	15		10	
CP731-1656	28	20	5.5	14	

Supplied With

- **CP731-0939**: Four pieces of hex. socket-head cap screws M4x0.7-10L
- **CP731-1246**: Four pieces of hex. socket-head cap screws M4x0.7-15L
- **CP731-1656**: Four pieces of hex. socket-head cap screws M5x0.8-20L

Reference

How To Use ONE-TOUCH FLEX LOCATORS
(Hexagon Head / Cam Handle)