

QZSD-C6-H

HOLDER (QUICK ZERO SETTING DEVICE)

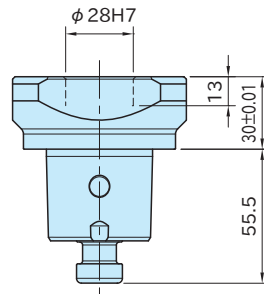
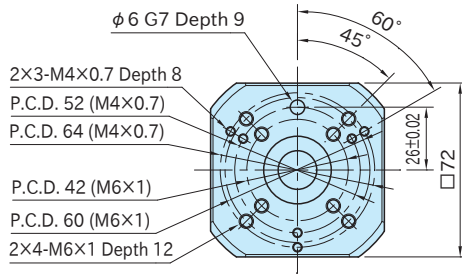

Body	Clamping Screw
SCM420 steel	SCM435 steel
Carburized-hardened	Quenched and tempered
Black oxide finished	Black oxide finished

Part Number	Weight (kg)
QZSD-C6-H	1.3

Feature

- Tapped holes for mounting fixtures on the top face.
- [CP120](#)-06501 OD HOLDING CLAMPS can be mounted directly.

Related Product

- [CP120](#) OD HOLDING CLAMP
- [MBID](#) ID HOLDING CLAMP
- [QZSD-C6-B](#) BASE (QUICK ZERO SETTING DEVICE)
- [QZSD-C6-P](#) PLATE (QUICK ZERO SETTING DEVICE)

Application Example

