

# AMWPD-M

# CLAMPING SCREWS

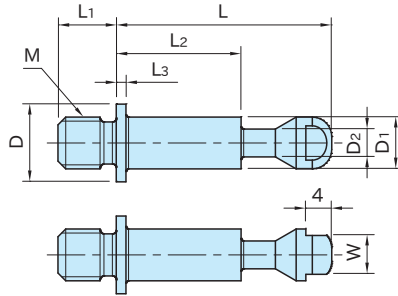

Body
Steel (SCM435)
Quenched and tempered
Black oxide finish

Part Number	D <sub>1</sub>	M	L <sub>1</sub>	L	D	L <sub>2</sub>	L <sub>3</sub>	D <sub>2</sub>	W	Proper Pull Clamps	Weight (g)
<b>AMWPD40-M 8</b>	8	M 8×1.25	9	38	12	24	1.5	4.3	6	AMWPD40-W	16
<b>AMWPD40-M10</b>		M10×1.5	11								20
<b>AMWPD63-M12</b>	12	M12×1.75	13	48	20	31.5	2	6.5	10	AMWPD63-W	50
<b>AMWPD63-M16</b>		M16×2	17								64

## How To Use

### Recommended Spacing Tolerance in Use of Clamping Screws

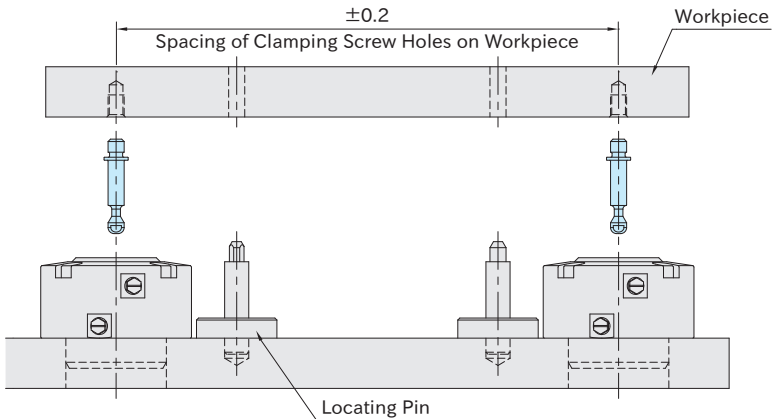

### Note

Custom Clamping Screws (different screw thread sizes) are available on request.