

# QCIC-F

# ONE-TOUCH INDEXING CLAMPS



**QCIC-F-2P**

(ON Position)

**QCIC-F-2P**

(OFF Position)



**QCIC-F-2P**

(Without Spring Pressure)



**QCIC-F-3P**

(With Spring Pressure)

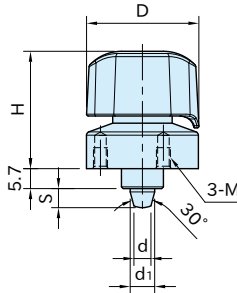
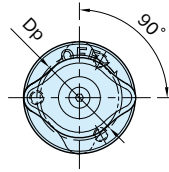

(ON Position)

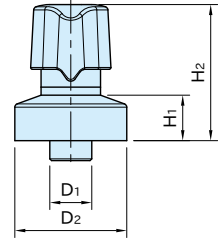

(OFF Position)

Body	Tapered Pin	Indicator	Knob
SCM440 steel Electroless nickel plated	SCM435 steel Electroless nickel plated	A5056 aluminum alloy Anodized Red	Polyamide (glass-fiber reinforced) Black

## ★ Key Point

Locating and clamping at once  
Easy to read ON/OFF position

Size	Proper Plate Thickness	D	D <sub>1</sub> ( <sup>-0.01</sup> / <sub>-0.03</sub> )	D <sub>2</sub>	H	H <sub>1</sub>	H <sub>2</sub>	d	d <sub>1</sub>	S	M	D <sub>p</sub>	Proper Tapered Bushings
<b>QCIC05F26</b>	6~14	26	10	26	29	11	33	3.3	5	4.2	M3×0.5 Depth 5	20	QCIC05TB
<b>QCIC07F32</b>	6~15	32	12	32	34	13	39	4.9	7	5	M4×0.7 Depth 6	24	QCIC07TB

Part Number	Clamping Force (N)	Spring Pressure (N)	Weight (g)
<b>QCIC05F26-2P</b>	140	—	60
<b>QCIC07F32-2P</b>	170	—	105
<b>QCIC07F32-3P</b>		9	110

## QCIC-TB TAPERED BUSHINGS



## Supplied With

- **QCIC05F26**: 3 of socket-head cap screws(Stainless Steel), M3×0.5-6L
- **QCIC07F32**: 3 of socket-low-head cap screws(Stainless Steel), M4×0.7-8L

## Feature

- Clamping by the tapered pin allows locating and fixing with no clearance at once.
- Use with the dedicated tapered bushing.
- ON/MID/OFF mark on the body and the knob position allow to visually recognize clamping or unclamping.
- The red indicator appears to show the unclamping state when the knob is in OFF position.

### ■ Without Spring Pressure

2 positions of ON/OFF

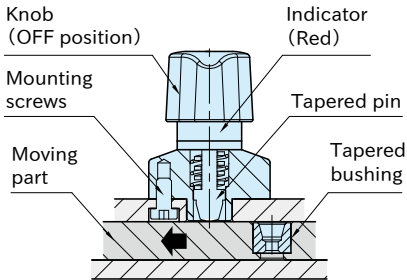

Knob is in OFF position.

The tapered pin remains inside when releasing the knob.

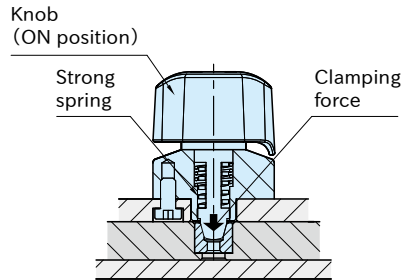

Knob is in ON position.

- Turn the knob to "ON" when the tapered pin and tapered bushing are aligned.
- Clamping force is generated by compressing strong spring and the tapered pin clamps the tapered bushing. The knob clicks when it is clamped.

### ■ With Spring Pressure

- 3 positions of ON/MID/OFF
- The plate is movable while receiving spring pressure of the coil spring inside the body.
- The tapered pin and tapered bushing automatically engage by spring pressure when they are aligned. (The knob positions in "MID".)

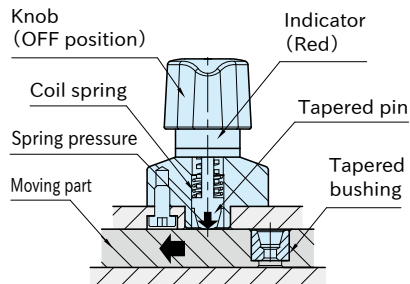

Knob is in OFF position.

The tapered pin keeps pushed-out-state when releasing the knob. (The knob turns to "MID".)

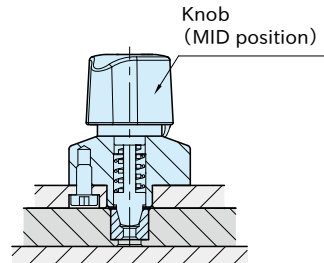

Knob is in MID position.

- The tapered pin and tapered bushing engage by spring pressure when they are aligned.
- The knob moves to "MID".
- Turn the knob from "MID" to "ON".
- Clamping force is generated by compressing strong spring and the tapered pin clamps the tapered bushing. The knob clicks when it is clamped.

 Continuing on Next Page

## Technical Information

Size	Heatresistant Temperature(°C)	Allowable Load (N)
QCIC05F26	80	900
QCIC07F32		1300

Repeatability:  $\pm 0.05$

## How To Use

### ■ Without Spring Pressure

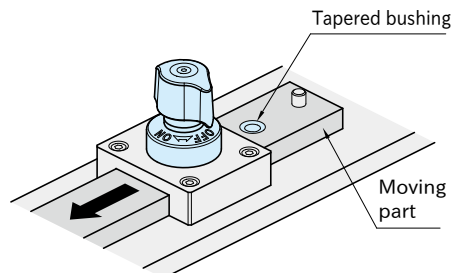

- ① Ensure that the knob is positioned at "OFF". Slide the moving part.

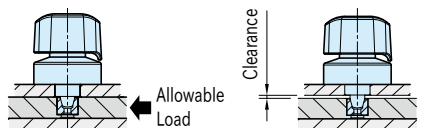

Recommended clearance between plates: 0.2 mm or less

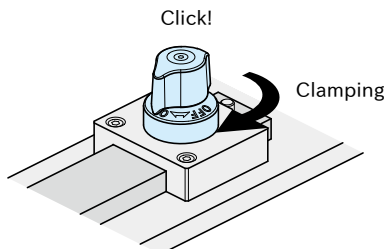

- ② Turn the knob to "ON" for clamping. The knob clicks when it is clamped.  
 Note: For [QCIC-F-2P](#) (Without spring pressure), do not unclamp when the tapered pin is receiving axial load. (The tapered pin could not return due to structure.)

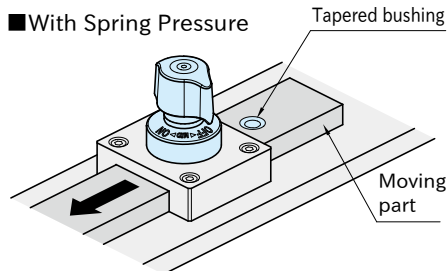

- ① Slide the moving part when the knob is positioned at "OFF".

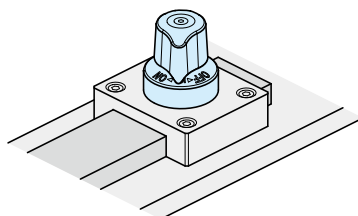

- ② The tapered pin and tapered bushing engage by spring pressure when they are aligned. The knob moves to "MID".

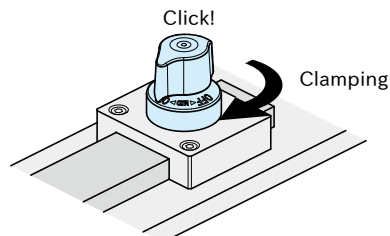

- ③ Turn the knob from "MID" to "ON" for clamping. The knob clicks when it is clamped.

## Application Example

Locating and clamping for sliding plate

ONE-TOUCH INDEXING  
CLAMPS  
QCIC-F-P

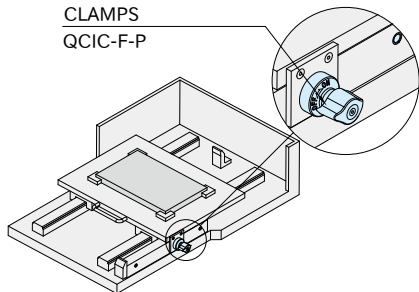

Locating and clamping for rotating unit

ONE-TOUCH INDEXING  
CLAMPS  
QCIC-F-P

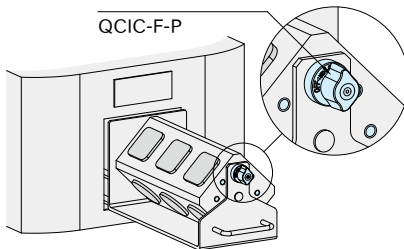

## How To Install

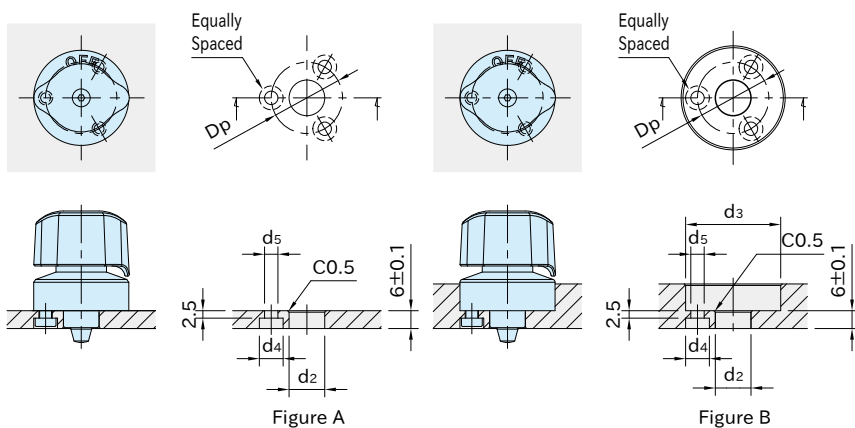

Figure A

Figure B

Size	Proper Plate Thickness	Figure	d <sub>2</sub> (H7)	d <sub>3</sub>	d <sub>4</sub>	d <sub>5</sub>	Dp
QCIC05F26	6	A	10	—	6.5	3.4	20
	Over 6, 14 or less	B		27			
QCIC07F32	6	A	12	—	8	4.5	24
	Over 6, 15 or less	B		33			

## Reference

"How To Install" of [QCIC-TB](#) Tapered Bushings.