

# QCSJS

## HEAVY DUTY SHAFT COUPLING CLAMP



Heat resistance: 180°C



★Key Point  
Strong clamping  
by the spring

2-Countersink  
For M4 Cone Point Setscrew

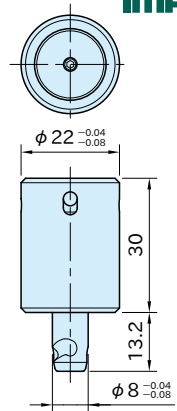
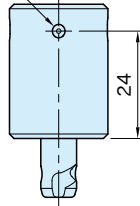

Body	Shank	Pin	Spring
S45C steel Electroless nickel plated	SKS3 steel Electroless nickel plated Quenched and tempered	SUS303 stainless steel	Equivalent to SWOSC-V steel

Part Number	Clamping Force (N)	Holding Force(N*)	Weight (g)	Proper Locking Receptacle	Proper Locking Receptacle
<b>QCSJS0822A</b>	400	400	76	QCSJS0822-S	QCTHS0834-B

\*) Exceeding the holding force creates a gap of greater than 0.1mm between plates.

### Supplied With

2 of cone point setscrews(stainless steel), M4×0.7-5L

# QCSJS-S

## LOCKING RECEPTACLE

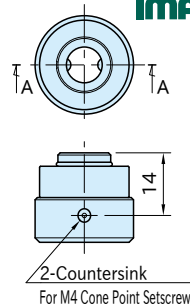
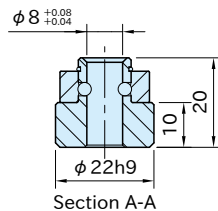

Part Number	Weight (g)	Body	Ball	Collar	Retaining Ring
<b>QCSJS0822-S</b>	42	S45C steel Electroless nickel plated	SUS440C stainless steel Quenched and tempered	SKS3 steel Electroless nickel plated Quenched and tempered	SUS304WPB stainless steel

### Supplied With

2 of cone point setscrews(stainless steel), M4×0.7-5L

### QCTHS-B Locking Receptacle



## Feature

When the cam groove moves along the balls inside the receptacle, the spring gets compressed to clamp the shafts.

### Installation on Shaft

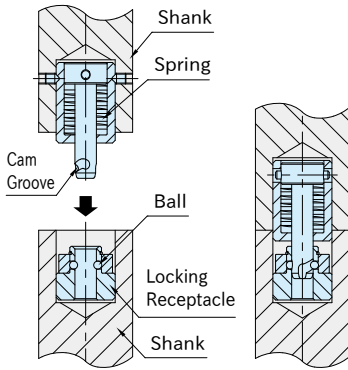

### Installation on Plate

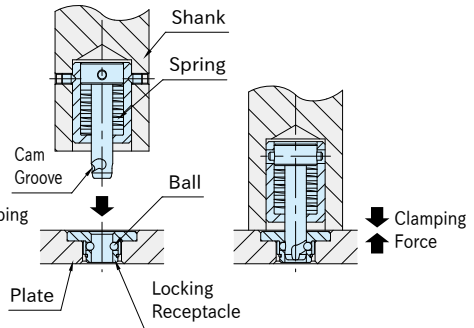

## How To Use

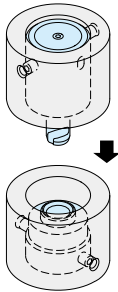

1. Align the cam groove with the ball in Locking Receptacle and insert.

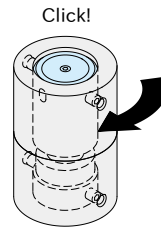
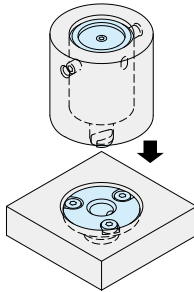

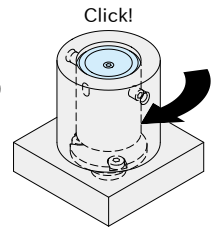

2. Turn the shaft for  $90^\circ$  to clamp. The element clicks when clamped. For unclamping, follow back these steps.

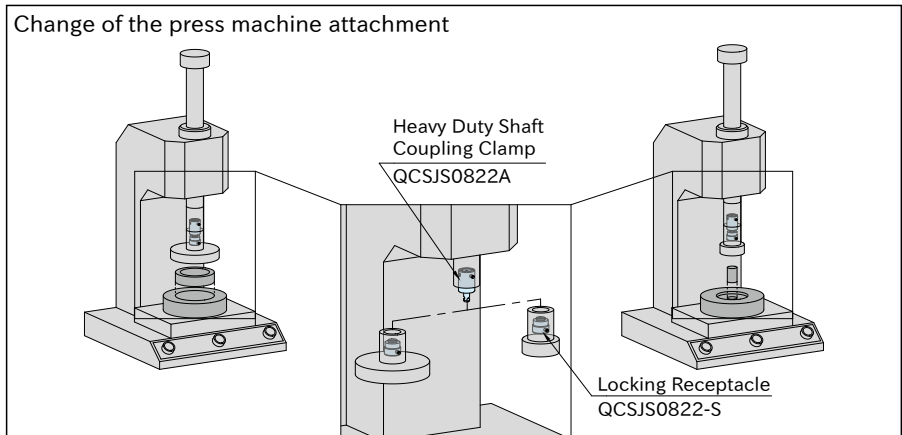

## Application Example

### Change of the press machine attachment



 Continuing on Next Page

## Application Example

Change of riser

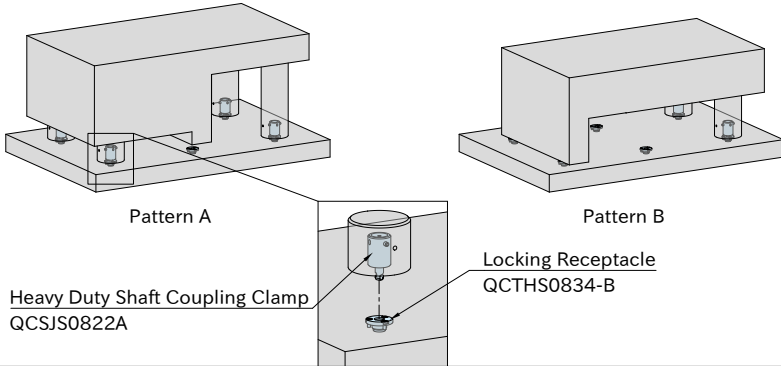

## Mechanical Strength

Heatresistant Temperature 180°C

Installation on Shaft

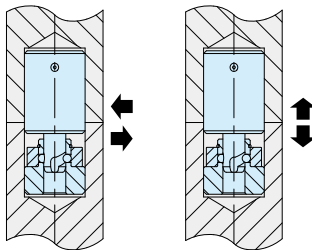

Shear Strength 4800N    Tensile Strength 1600N

Installation on Plate

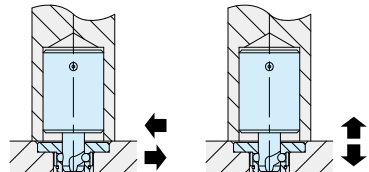

Shear Strength 4800N    Tensile Strength 1600N

Shear and tensile strength is allowable load and the fastener could break when it receives bigger load.

## Mounting Direction

Installation on Shaft

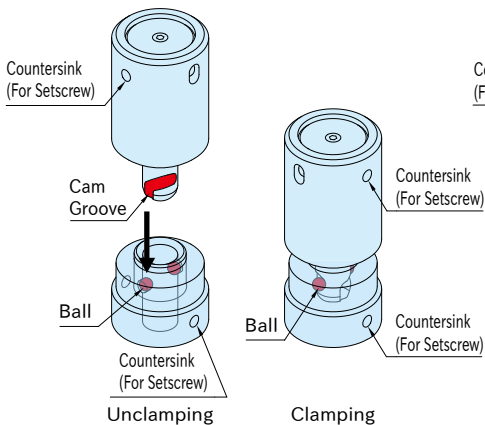

Installation on Plate

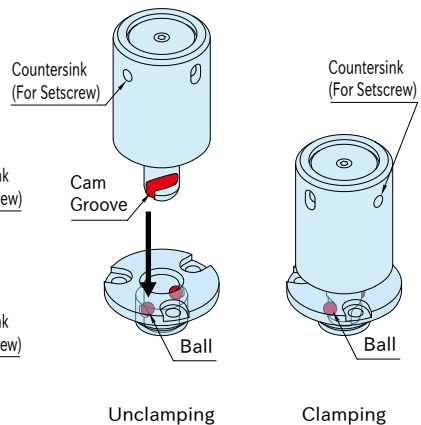

## How To Install

### Installation on Shaft

#### Heavy Duty Shaft Coupling Clamp

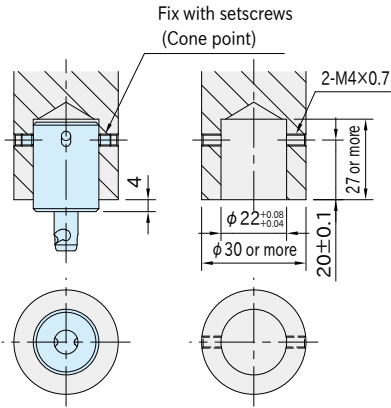

#### Locking Receptacle (QCSJS0822-S)

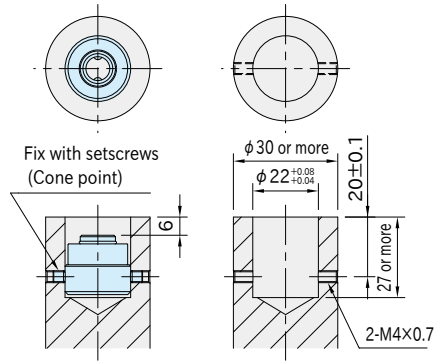

### Installation on Plate

#### Heavy Duty Shaft Coupling Clamp

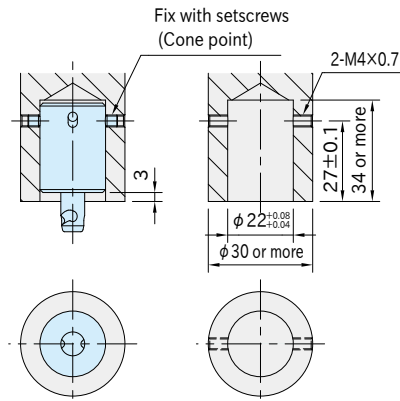

#### Locking Receptacle (QCTHS0834-B)

Plate thickness should be 9mm or more.

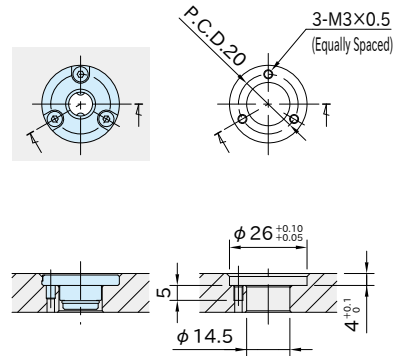

## Note

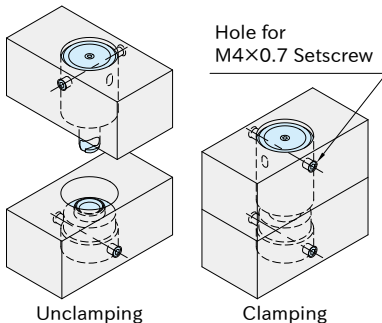

Decide the mounting hole position depending on the clamped part direction.

## Repeatability

Repeatability ±0.08

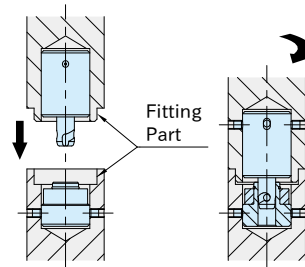

Prepare male and female fittings for higher accurate locating.