

# BJ156-A

## TAPPED-RADIUS CLAMP ASSEMBLIES, A Type



**[Stud]**

Material : SCM435 steel  
 Heat Treat : Quenched and tempered  
 Finish : Black oxide

**[Others]**

Material : S45C steel  
 Heat Treat : Quenched and tempered  
 Finish : Black oxide

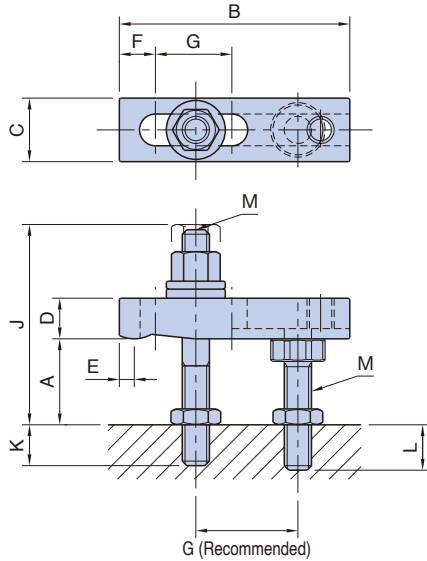

Part Number	A	B	C	D	E	F	G	H	J Max.	K	L	M	Clamping Force (N) At Max. - Min. End Projection	Allowable Screw Torque (N·m)	Weight (kg)
BJ156-08050A1	15 - 25	50	19	12	5	12	14	20	51	12	22 - 12	M 8x1.25	4,600 - 6,600	17	0.13
BJ156-08050A2	20 - 35								66	14	27 - 12				
BJ156-08063A1	15 - 25	63	19	12	5	12	14	20	51	12	22 - 12	M 8x1.25	3,600 - 6,600	17	0.14
BJ156-08063A2	20 - 35								66	14	27 - 12				
BJ156-08080A1	15 - 25	80	19	16	5	15	34	25	55	12	22 - 12	M 8x1.25	3,600 - 6,600	17	0.19
BJ156-08080A2	20 - 35								66	14	27 - 12				
BJ156-10063A1	20 - 30	63	25	12	5	15	18	25	62	18	20 - 10	M 10x1.5	7,300 - 10,600	34	0.23
BJ156-10063A2	25 - 45								80	20	30 - 10				
BJ156-10080A1	20 - 30	80	25	16	5	15	32	30	63	18	20 - 10	M 10x1.5	8,800 - 15,000	45	0.29
BJ156-10080A2	25 - 45								80	20	30 - 10				
BJ156-10100A1	20 - 30	100	19	16	5	15	40	40	66	18	20 - 10	M 10x1.5	9,500 - 16,400	45	0.4
BJ156-10100A2	20 - 45								81	20	35 - 10				
BJ156-12063A1	20 - 40	63	32	16	6	14	14	30	80	20	33 - 13	M 12x1.75	15,300 - 20,200	71	0.38
BJ156-12063A2	45 - 55								101	24	23 - 13				
BJ156-12080A1	20 - 40	80	32	16	6	14	25	30	80	20	33 - 13	M 12x1.75	11,800 - 17,800	71	0.43
BJ156-12080A2	45 - 55								101	24	23 - 13				
BJ156-12100A1	20 - 40	100	32	19	6	20	40	35	80	20	33 - 13	M 12x1.75	12,300 - 21,200	80	0.52
BJ156-12100A2	40 - 55								101	24	28 - 13				
BJ156-12125A1	20 - 40	125	32	19	6	20	50	50	80	20	33 - 13	M 12x1.75	13,900 - 23,800	80	0.63
BJ156-12125A2	40 - 55								101	24	28 - 13				
BJ156-12160A1	20 - 40	160	25	16	6	20	60	75	85	20	33 - 13	M 12x1.75	18,100 - 29,600	90	0.96
BJ156-12160A2	35 - 55								101	24	33 - 13				

Part Number	A	B	C	D	E	F	G	H	J Max.	K	L	M	Clamping Force (N) At Max. - Min. End Projection	Allowable Screw Torque (N·m)	Weight (kg)			
<b>BJ156-16080A1</b>	25 - 35	80		19		18	17		81	20	28 - 18		19,200 - 24,800	115	0.72			
<b>BJ156-16080A2</b>	35 - 50								96	30	33 - 18				0.77			
<b>BJ156-16100A1</b>	25 - 35	100		22					40	84	20	28 - 18	15,100 - 22,100		0.88			
<b>BJ156-16100A2</b>	35 - 50								30	99	30	33 - 18			0.94			
<b>BJ156-16125A1</b>	25 - 35	125	38		6		25			45	50		M16x2	16,800 - 26,900	129	1.06		
<b>BJ156-16125A2</b>	35 - 50															102	24	33 - 18
<b>BJ156-16160A1</b>	25 - 35	160		25						65	65			16,900 - 29,100		1.24		
<b>BJ156-16160A2</b>	35 - 50															87	20	28 - 18
																102	24	33 - 18