

BJ200(Heavy)

DOWNTHRUST BACKSTOPS



[Body]

Material : FCD450 cast iron

Finish : Black powder baking

[Jaw]

Material : S50C steel

Heat treat : Induction hardened

(jaw serrations)

Finish : Black oxide

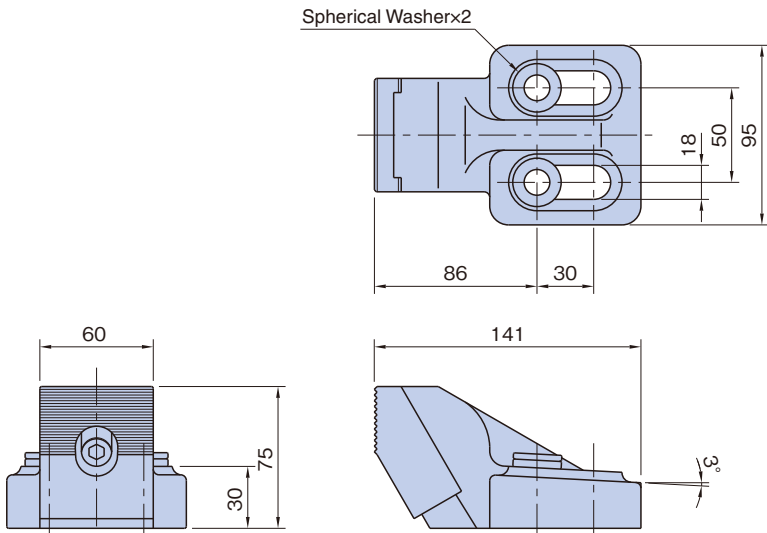

Part Number	Load Capacity (N)	Jaw-Moving Load (N)	Weight (kg)
BJ200-16075	60.000	280	2.4

2 spherical washers for both M12 and M16 screws are included.

Feature:

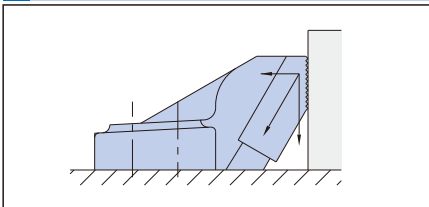

These backstops work to provide downholding force and prevent part lift.