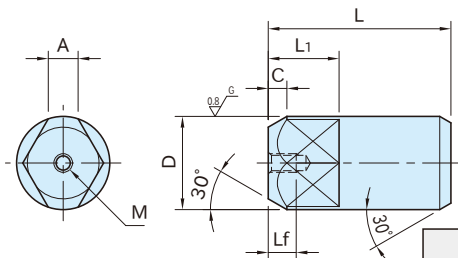

**BJ722****DIAMOND LOCATING PINS**

Body
SK95 steel
Quenched and tempered (Rc 55 - 60)
Precision ground

Part Number	D (h6)	L	L <sub>1</sub>	A	C	M	L <sub>f</sub>	Weight (g)
<b>BJ722-06001</b>	6	20	9	1.8	2	M3×0.5	6	3
<b>BJ722-08001</b>	8	25	11	2.2	3			7
<b>BJ722-10001</b>	10	30	13	3	4			13
<b>BJ722-12001</b>	12	34	14	3.5	4	M5×0.8	10	25
<b>BJ722-14001</b>	14	38	15	4				40
<b>BJ722-16001</b>	16	42	16	5	5			60
<b>BJ722-18001</b>	18	46	17	5.5				85
<b>BJ722-20001</b>	20	47		6				100
<b>BJ722-22001</b>	22	49	19	7	140			
<b>BJ722-25001</b>	25			8	165			

**Related Product Pages**

Use Pin Extractors to pull out these pins.