

QCPC

PIN HOLDING CLAMPS



Stainless Steel



QCPC



QCPC-S

(OFF position)



QCPC-SUS

Stainless Steel



QCPC

(ON position)

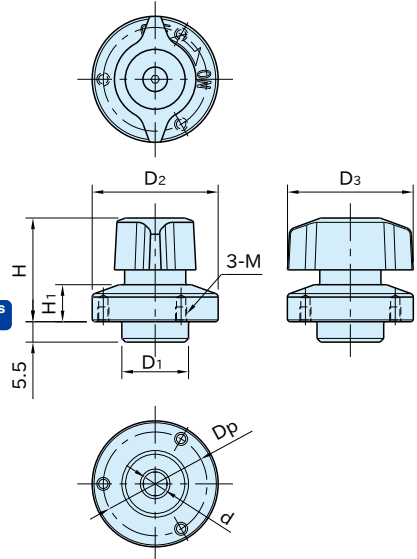

★Key Point

Minimises space requirement with clamping pins.

| Type | Body | Shaft | Knob | Ball | Spring |
|----------|------------------------|---|---|--|---------------------------|
| QCPC | SUS303 stainless steel | S45C steel Electroless nickel plated | Polyamide (glass-fiber reinforced) Black | SUS440C stainless steel Quenched and tempered | SUS304WPB stainless steel |
| QCPC-S | | | SCS13 stainless steel (Equivalent to SUS304) | | |
| QCPC-SUS | | SUS303 stainless steel | | | |

| Size | | Proper Plate Thickness | d (+0.4 /+0.2) | D1 (h9) | D2 | D3 | H | H1 | M | Dp | Clamping Force (N) | Holding Force (N)** | Proper Clamping Pins |
|----------|---------|------------------------|----------------|---------|----|----|----|-----|-------------------|----|--------------------|---------------------|----------------------|
| QCPC | 0625-10 | 3~10 *) | 6 | 14 | 25 | 25 | 23 | 6.5 | M2×0.4 Depth 3 | 21 | 7 | 110 | QCPC0625-M4-SUS |
| QCPC-S | | | | | | | | | | | | | |
| QCPC-SUS | 0834-14 | 3~14 *) | 8 | 18 | 34 | 34 | 28 | 10 | M3×0.5 Depth 4 | 28 | 9 | 150 | QCPC0834-M5-SUS |

*) Spacer [QCASP] is required for thinner plate than 6mm.

**) Exceeding the holding force creates a gap of greater than 0.1mm between plates.

| QCPC (Plastic Knob) | | QCPC-S (Metal Knob) | | QCPC-SUS (Stainless Steel) | |
|---------------------|------------|---------------------|------------|----------------------------|------------|
| Part Number | Weight (g) | Part Number | Weight (g) | Part Number | Weight (g) |
| QCPC0625-10 | 35 | QCPC0625-10S | 45 | QCPC0625-10-SUS | 45 |
| QCPC0834-14 | 85 | QCPC0834-14S | 105 | QCPC0834-14-SUS | 105 |



Supplied With

- QCPC QCPC-S QCPC-SUS 0625-10 : 3 of socket-head cap screws(stainless steel), M2×0.4-5L
- QCPC QCPC-S QCPC-SUS 0834-14 : 3 of socket-head cap screws(stainless steel), M3×0.5-6L

Feature

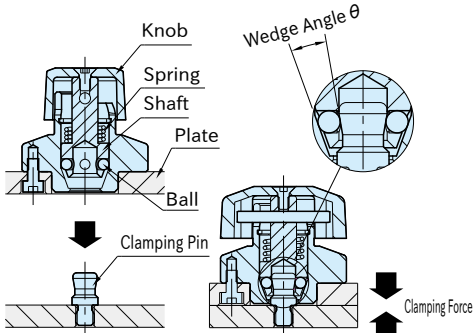

Four balls hold the Clamping Pin to pull the plate for clamping.

How To Use

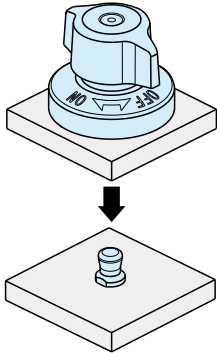

1. Ensure that the knob is positioned at the "OFF" mark and put Pin Holding Clamp over the Clamping Pin.

Mechanical Strength

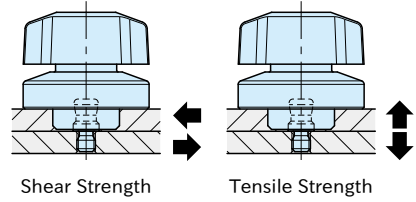

| Size | | Heatresistant Temperature (°C) | Shear Strength (N) | Tensile Strength (N) |
|----------|---------|--------------------------------|--------------------|----------------------|
| QCPC | 0625-10 | 130 | 1100 | 250 |
| | 0834-14 | | 1800 | 400 |
| QCPC-S | 0625-10 | 180 | 1100 | 250 |
| QCPC-SUS | 0834-14 | | 1800 | 400 |

Shear and tensile strength is allowable load and the fastener could break when it receives bigger load.

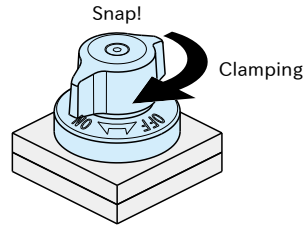

2. Turn the knob to the "ON" mark for clamping.
Note: For unclamping, follow back these steps.

Application Example

Changes of guides around star wheels

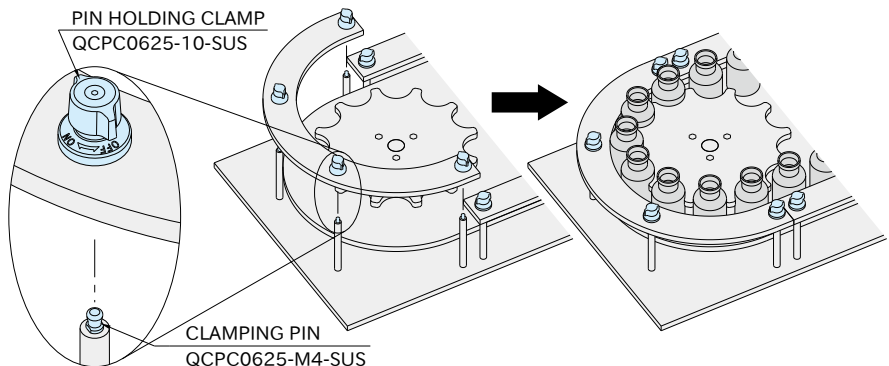

Continuing on Next Page

Application Example

Changes of static electricity removal brush

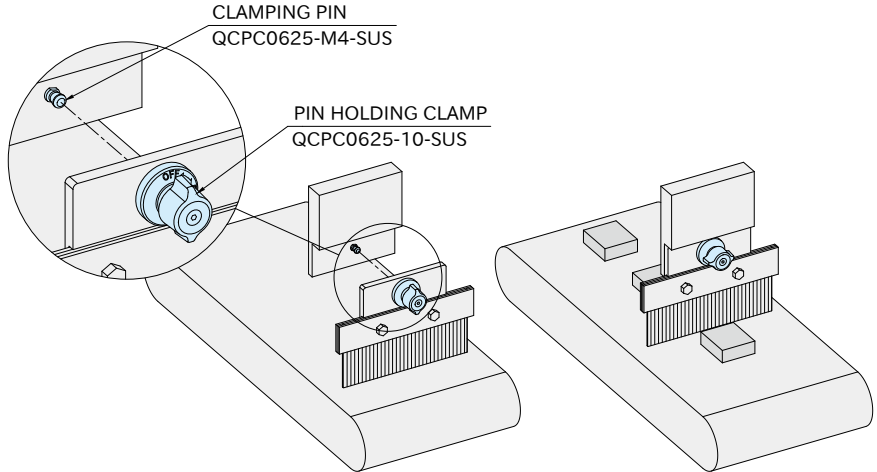

How To Install

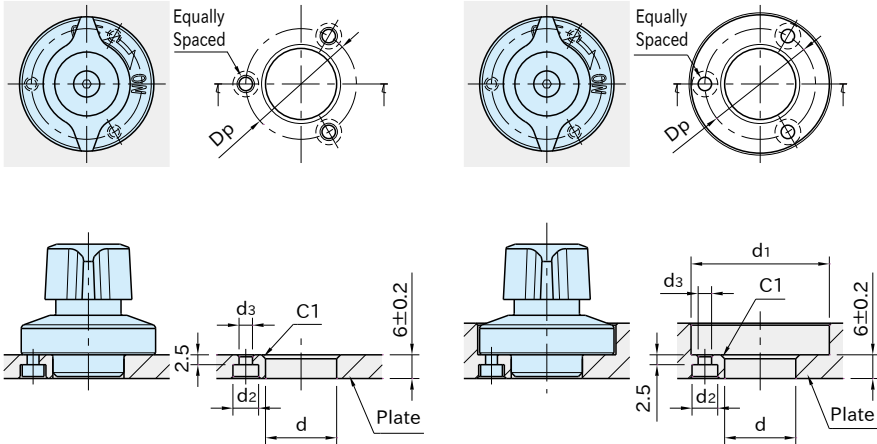

Figure A

Figure B

| Size | | Proper Plate Thickness | Figure | d (+0.10 +0.05) | d ₁ | d ₂ | d ₃ | D _p |
|---|----------------|------------------------|----------------------------------|-----------------------|----------------|----------------|----------------|----------------|
| QCPC QCPC-S QCPC-SUS | 0625-10 | 3 or more, under 6 | Spacer QCASP is required. | | | | | |
| | | 6 | A | 14 | — | 4.4 | 2.4 | 21 |
| | | Over 6, 10 or less | B | — | 26 | — | — | — |
| QCPC QCPC-S QCPC-SUS | 0834-14 | 3 or more, under 6 | Spacer QCASP is required. | | | | | |
| | | 6 | A | 18 | — | 6.5 | 3.4 | 28 |
| | | Over 6, 14 or less | B | — | 35 | — | — | — |

Accuracy

■ Machining Accuracy

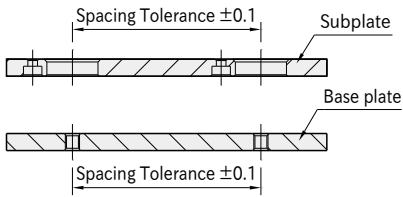

Spacing tolerance on both the subplate and the base plate should be ± 0.1 .

■ Repeatability

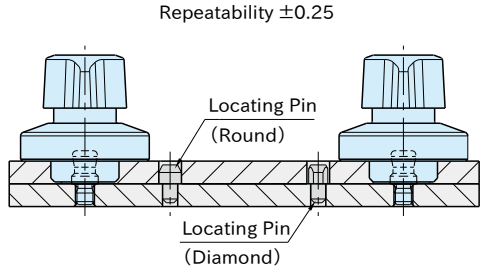

For higher accurate locating, use locating pins.

🔪 Note

Rotation of either sub plate or base plate can get Pin Holding Clamp unclamped, when one pair of the clamp and the clamping pin is used. Prepare a stop in such application.

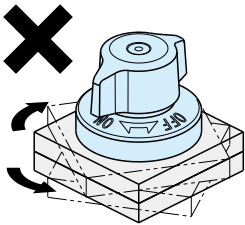

Reference

- "How To Install" of [QCPC-M](#) Clamping Pins
- Spacer [QCASP](#) is required for 3mm or more, under 6mm plate thickness.

QCASP SPACERS

