

Pneumatic Flex Locators

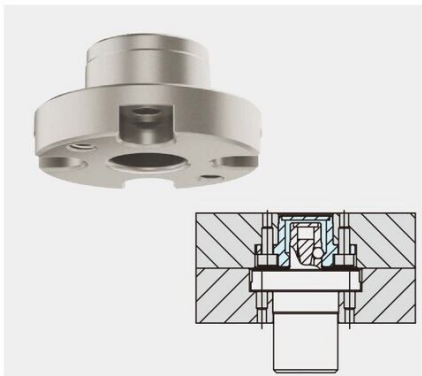



LOCATING RECEIVERS

Part No. AMWF-BU

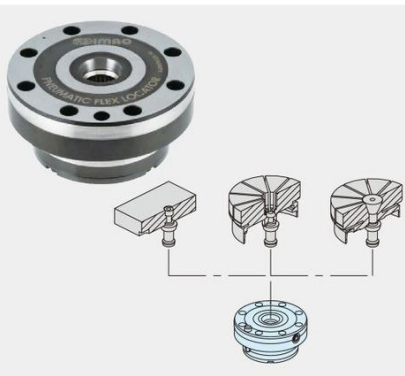

PNEUMATIC CLAMPING MODULES

Part No. AMWFH-WP



CLAMPING PINS

Part No. AMWFH-M



PNEUMATIC CLAMPING MODULES

Part No. AMWFH-S



CLAMPING PINS

Part No. AMWFH-M



PNEUMATIC CLAMPING LOCATORS

Part No. AMWF-L-S

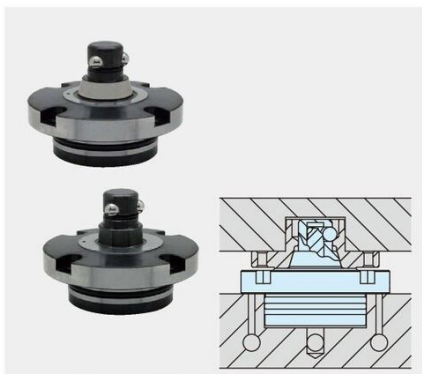

PNEUMATIC CLAMPING LOCATORS

Part No. AMWF-W



LOCATING RECEIVERS

Part No. AMWF-BU

AMWFH-S

PNEUMATIC CLAMPING MODULES

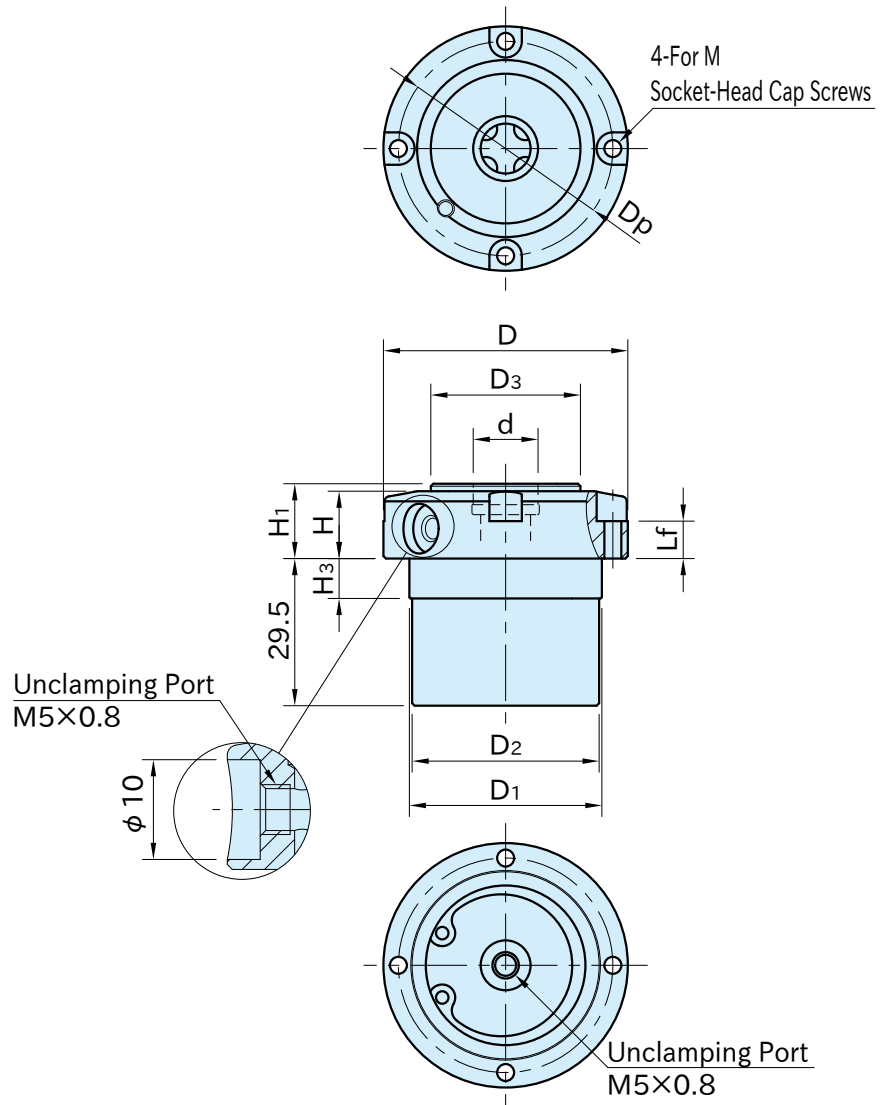

★Key Point

High clamping force by spring-loaded mechanical lock.

Body	Ball	Spring
SCM440 steel Electroless nickel plated	SUS440C stainless steel	Equivalent to SWOSC-V steel

Part Number	D_1 ($_{-0.01}$ $_{-0.04}$)	H_3	D_2	D	H	D_3	H_1 (± 0.02)	d ($_{+0.01}$ $_{+0.04}$)	M	L_f	D_p
AMWFH49-S	38	8	37.5	49	13.5	30	15	13	M3	7.5	43
AMWFH64-S	48	10	47.5	64	18	40	20	15	M4	10.5	56

Part Number	Air Pressure (MPa) *	Clamping Force (kN)	Holding Force (kN) **	Weight (g)	Clamping Pins
AMWFH49-S	0.3	0.6	3	370	AMWFH49-M6L, AMWFH49-M6S
AMWFH64-S		1	4	760	AMWFH64-M8L, AMWFH64-M8S

*) For unclamping

**) Exceeding the holding force will result in product failure. This value does not include a safety factor.

Reference

How To Install PNEUMATIC CLAMPING MODULES

Related Product

[AMWFH-M](#) CLAMPING PINS

Feature

Single acting and spring clamping module. Supply air for unclamping, release for clamping.

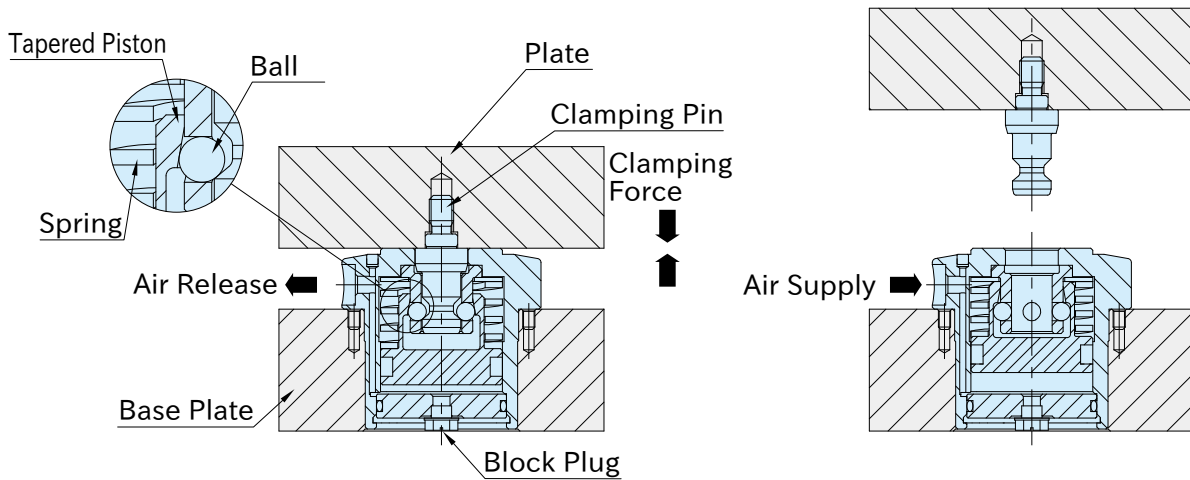

Releasing air allows the spring to push down the tapered piston. The balls pushed by the piston pull down the clamping pin. Keeps clamping without air supply.

Supplying air allows the tapered piston to rise. The balls become loose and the clamping pin is released.

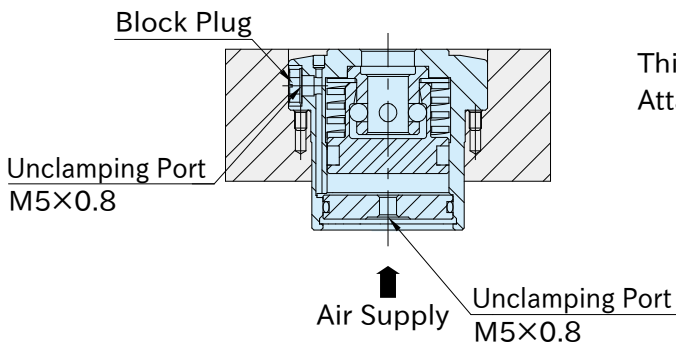

This module has 2 pneumatic ports for unclamping. Attach the furnished block plug to the unused port.

How To Use

■ Clamping Pin

Use accurate clamping pins for locating.
 Note: Use accurate clamping pins for 2 places and standard ones for other places when using 3 clamping pins or more.

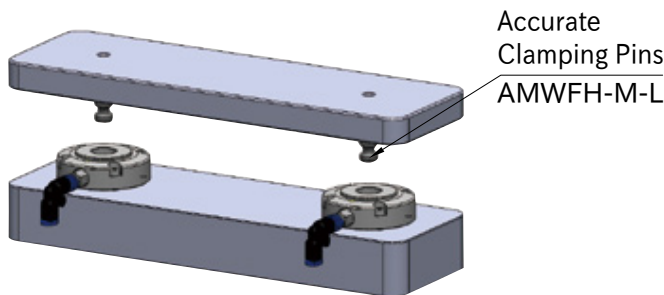

■ Repeatability

Repeatability $\pm 30 \mu\text{m}$

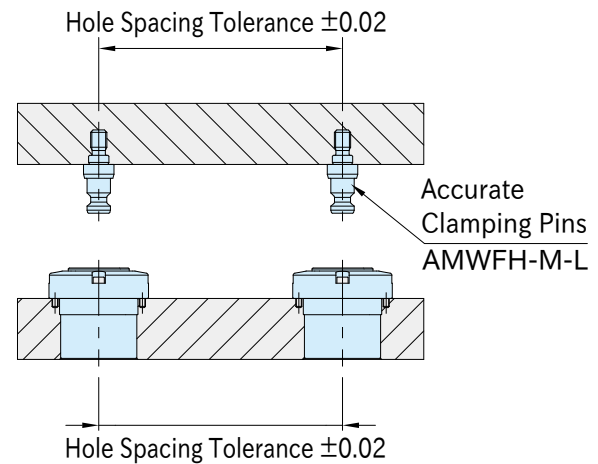

🔧 Note

- Use clean air by removing moisture and debris with an air dryer and air filter.
- Impurities in the compressed air can cause malfunction.

AMWFH-M

CLAMPING PINS



AMWFH-M-L
(Accurate)



AMWFH-M-S
(Standard)

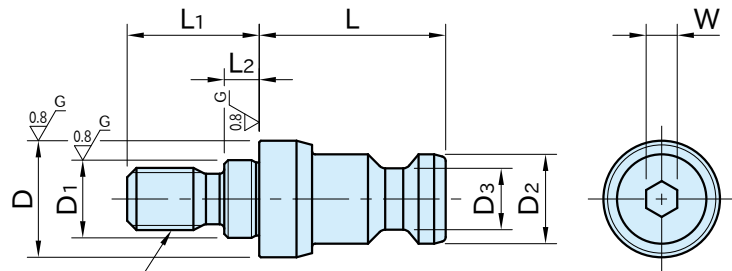

AMWFH-M-L
(Accurate)

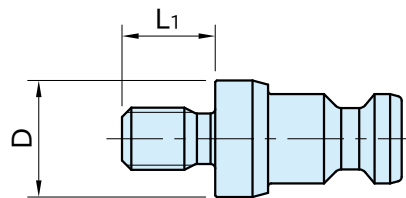

AMWFH-M-S
(Standard)

Body
SCM435 steel
Quenched and tempered
Electroless nickel plated

■ Accurate

Part Number	M	D ₁ (g6)	L ₂	L ₁	D (f7)	L	D ₂	D ₃	W	Weight (g)	Pneumatic Clamping Modules
AMWFH49-M6L	M6×1	8	3.5	13	13	21	9.5	5.9	3	15	AMWFH49-S
AMWFH64-M8L	M8×1.25	10	4.5	17	15	24	11.5	7.9	4	28	AMWFH64-S

■ Standard

Part Number	M	L ₁	D (^{-0.2} / _{-0.4})	L	D ₂	D ₃	W	Weight (g)	Pneumatic Clamping Modules
AMWFH49-M6S	M6×1	9	13	21	9.5	5.9	3	14	AMWFH49-S
AMWFH64-M8S	M8×1.25	12	15	24	11.5	7.9	4	25	AMWFH64-S

Reference

How To Install PNEUMATIC CLAMPING MODULES

Related Product

[AMWFH-S](#) PNEUMATIC CLAMPING MODULES

How To Install PNEUMATIC CLAMPING MODULES

How To Use

■ Mounting Hole Dimension

· Pneumatic Clamping Modules

Flange Mounting

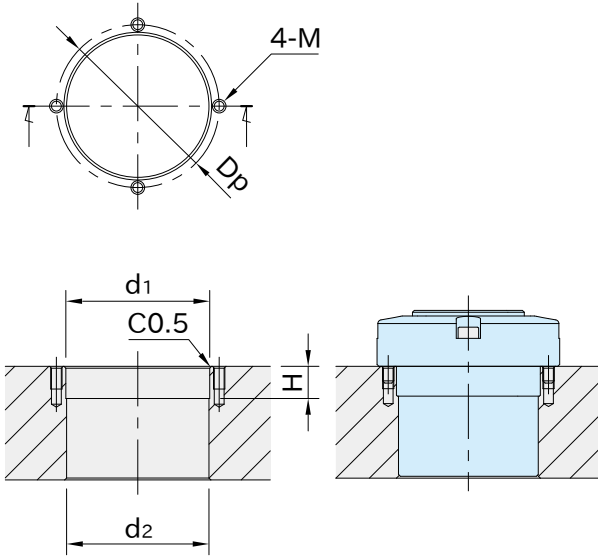

Flush Mounting

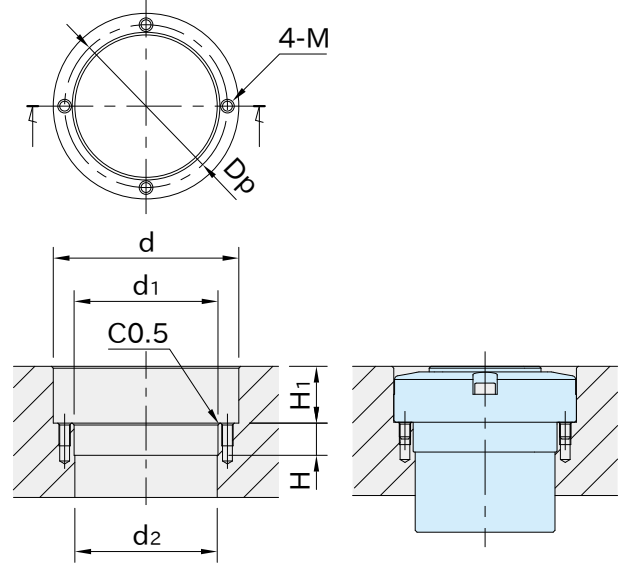

Part Number	d ₁ (H7)	H	d ₂	d	H ₁ (±0.05)	M	Dp
AMWFH49-S	38	8.5	37.8	50	15.1	M3×0.5 Depth 6	43
AMWFH64-S	48	10.5	47.8	65	20.1	M4×0.7 Depth 8	56

· Clamping Pins

AMWFH-M-L

(Accurate)

AMWFH-M-S

(Standard)

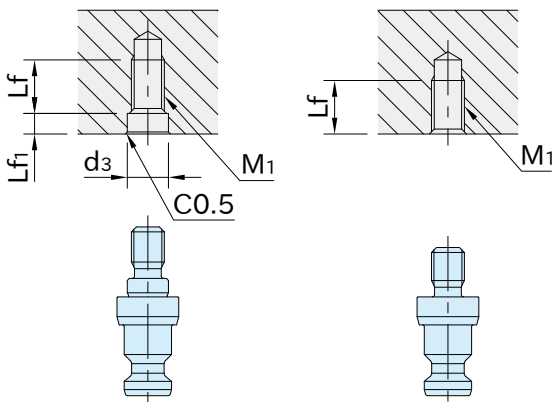

■ Machining Accuracy

AMWFH-M-L Accurate Clamping Pins



AMWFH-S Pneumatic Clamping Modules

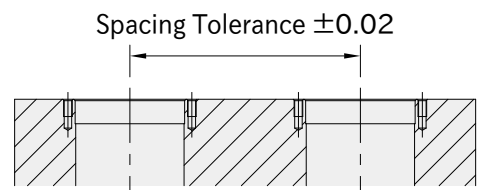

Part Number	M ₁	L _f	d ₃ (H7)	L _{f1}
AMWFH49-M6L	M6×1	10	8	4
AMWFH64-M8L	M8×1.25	13	10	5
AMWFH49-M6S	M6×1	10	—	—
AMWFH64-M8S	M8×1.25	13	—	—

AMWF-L-S

PNEUMATIC FLEX LOCATOR PINS



AMWF-L-S



AMWF-L-S-G

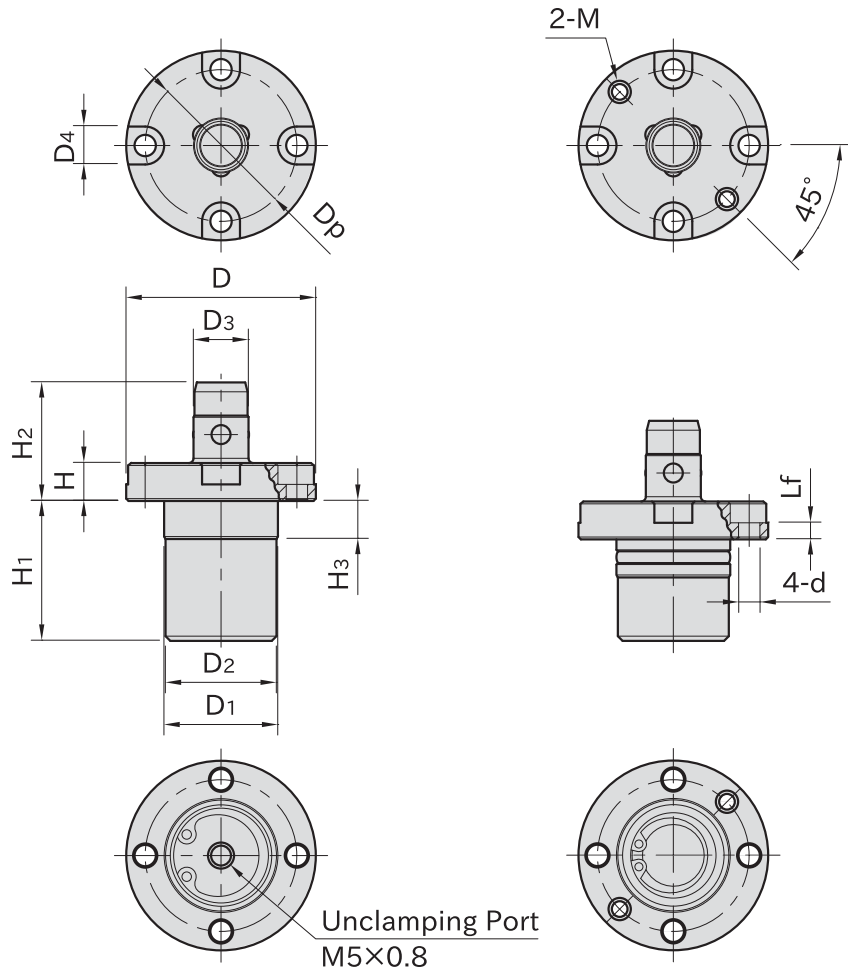

AMWF-L-S (Port Style)

AMWF-L-S-G (Direct Style)

Body	Ball	Coiled Spring
S45C steel Electroless nickel plated	SUS440C stainless steel	SUS304WPB stainless steel

Part Number	D ₁ (g6)	H ₃	D ₂	H ₁	D	H	D ₃ (h8)	H ₂	d	L _f	D ₄	D _p
AMWF18L-4S	24	8	23.4	29.5	40	8	12	25	4.5	3.5	8	32
AMWF26L-4S	32	8.5	31.4	31.7	51	9.5	16	28.5	5.5	4	9.5	41
AMWF18L-4S-G	24	8	23.4	24.5	40	8	12	25	4.5	3.5	8	32
AMWF26L-4S-G	32	8.5	31.4	25.5	51	9.5	16	28.5	5.5	4	9.5	41

Part Number	M	Air Pressure (MPa)	Clamping Force (N)	Weight (g)
AMWF18L-4S	—	0.5	250	154
AMWF26L-4S	—		350	289
AMWF18L-4S-G	M4×0.7		250	136
AMWF26L-4S-G	M5×0.8		350	252

Reference

- How To Install PNEUMATIC FLEX LOCATORS
- How To Use PNEUMATIC FLEX LOCATORS

Related Product

[AMWF-BU](#) PNEUMATIC FLEX LOCATOR BUSHINGS

AMWF-BU

PNEUMATIC FLEX LOCATOR BUSHINGS

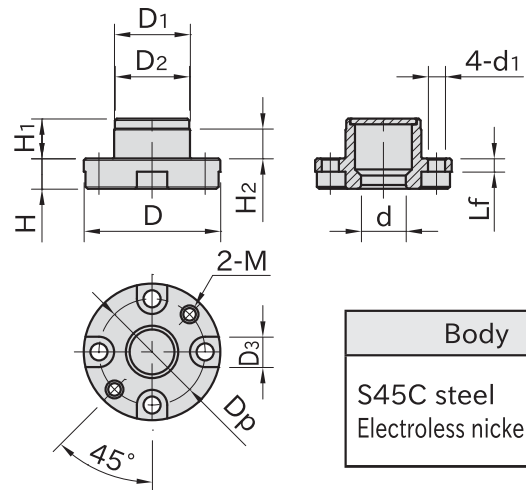

Body
S45C steel Electroless nickel plated

Part Number	D ₁ (g6)	H ₂	D ₂	H ₁	D	H	d (E7)	d ₁	Lf	D ₃	M	Dp	Weight (g)
AMWF18-BU	20	7.5	19.6	10.5	36	8	12.1	4.5	3.5	8	M4×0.7	28	57
AMWF26-BU	25	7	24.6	11	44	9.5	16.1	5.5	4	9.5	M5×0.8	34	97

Reference

- How To Install PNEUMATIC FLEX LOCATORS
- How To Use PNEUMATIC FLEX LOCATORS

Related Product

[AMWF-L-S](#) PNEUMATIC FLEX LOCATOR PINS

Feature

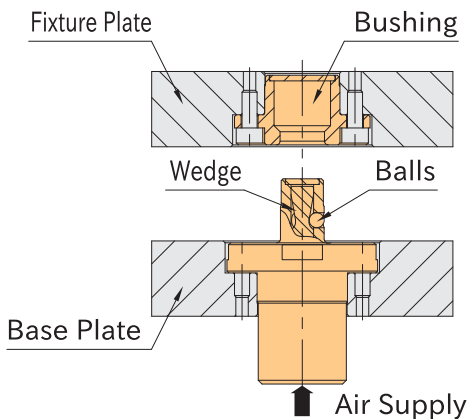

Supply air for unclamping.
The wedge goes up and releases the balls.

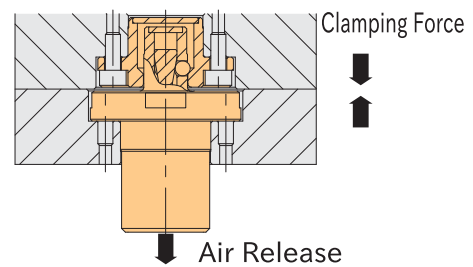

Release air for clamping. The wedge goes down and pushes the balls to pull down the bushing.
Can keep clamped without air supply.

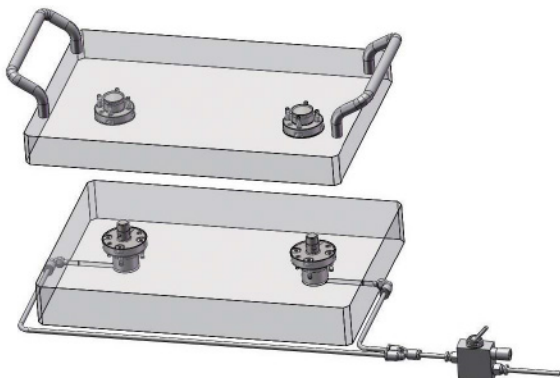

Quick clamping and unclamping reduce set-up time in production equipment.

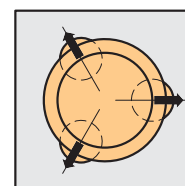

Locating Repeatability : $\pm 10 \mu\text{m}$
The bushing is centered and clamped when the 3 balls are pushed out to gain high locating repeatability.

How To Install PNEUMATIC FLEX LOCATORS

■ Mounting Hole Dimensions

· Pins

AMWF-L-S (Port Style)

AMWF-L-S-G (Direct Style)

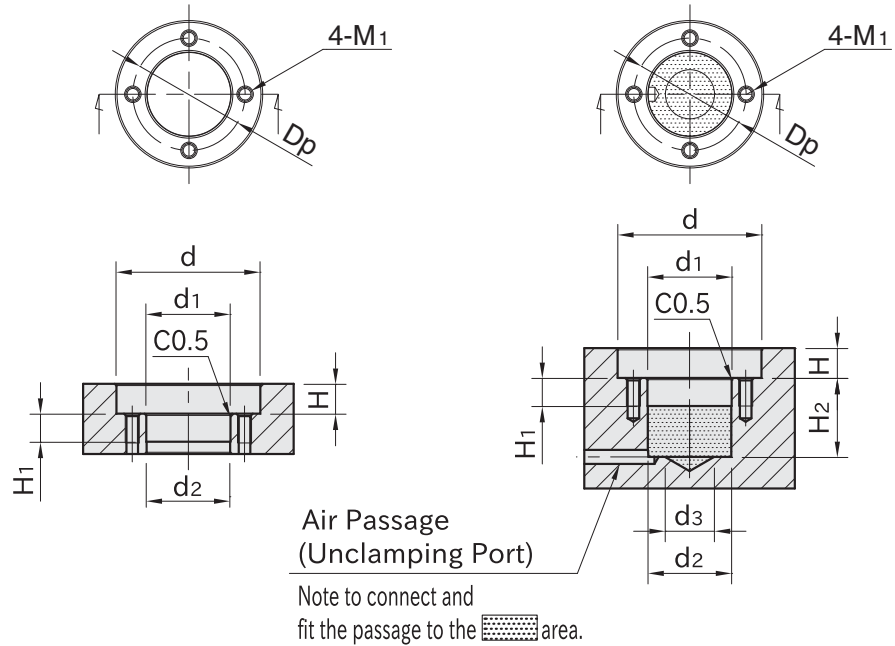

Part Number	d ₁ (H7)	H ₁	d ₂	H ₂	d ₃	d	H (±0.05)	M ₁	D _p
AMWF18L-4S	24	8.5	23.8	—	—	41	8.5	M4×0.7 Depth 8	32
AMWF26L-4S	32	9	31.8	—	—	52	10	M5×0.8 Depth10	41
AMWF18L-4S-G	24	8.5	23.8	25.5	14	41	8.5	M4×0.7 Depth 8	32
AMWF26L-4S-G	32	9	31.8	26.5	20	52	10	M5×0.8 Depth10	41

· Bushings

AMWF-BU (Bushing)

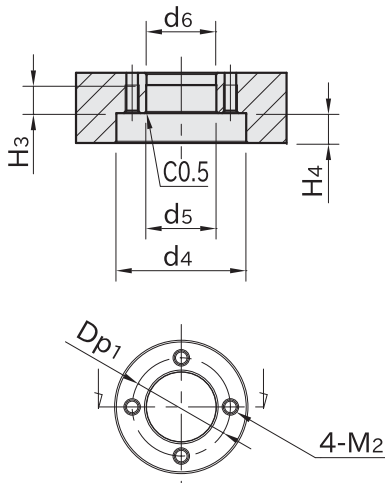

■ Spacing Tolerance

AMWF-BU (Bushing)

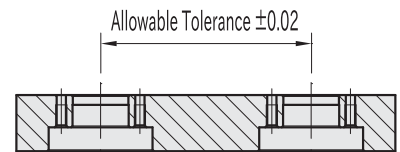

AMWF-L-S (Port Style)

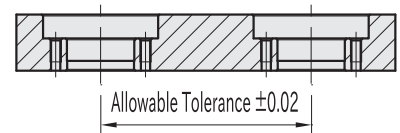

AMWF-L-S-G (Direct Style)

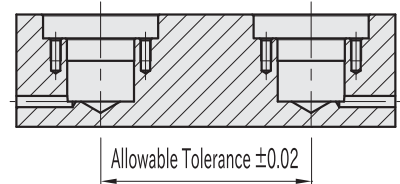

Part Number	d ₅ (H7)	H ₃	d ₆	d ₄	H ₄ (±0.05)	M ₂	D _{p1}
AMWF18-BU	20	8	19.8	37	8.5	M4×0.7 Depth 8	28
AMWF26-BU	25	7.5	24.8	45	10	M5×0.8 Depth10	34

How To Use PNEUMATIC FLEX LOCATORS

How to Use

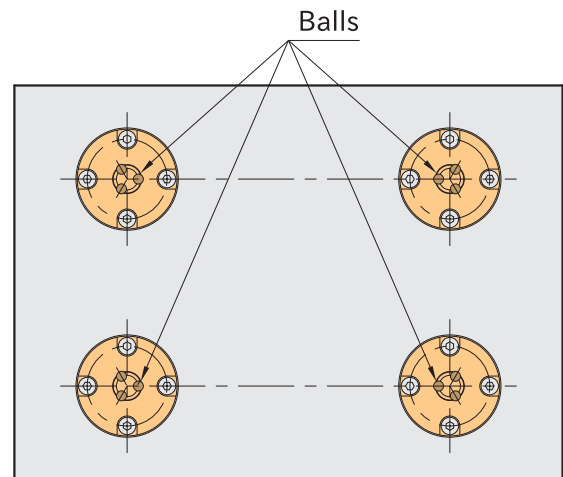
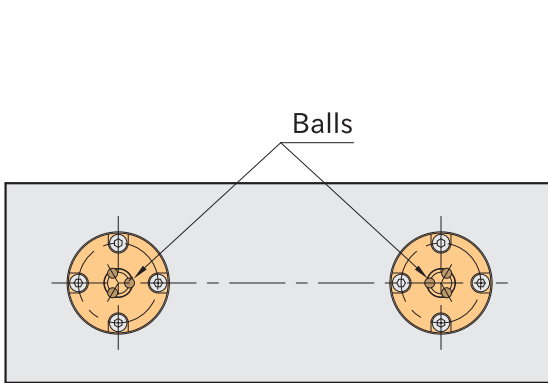

The pins should be mounted in the direction shown in the above figures.

How to Remove (Direct Style Pins)

For easier removal, insert screws into the tapped holes and screw them.

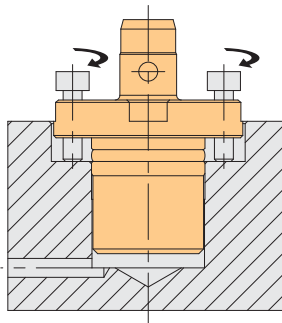

How to Remove (Bushings)

For easier removal, insert screws into the tapped holes and screw them.

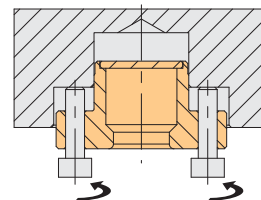

Note

Size	Max. Loading Weight (kg)
AMWF18	40
AMWF26	56

- If the total weight exceeds the maximum loading weight, the locating repeatability may exceed $\pm 10 \mu\text{m}$.
- In vertical use, the locating repeatability may exceed $\pm 10 \mu\text{m}$.
- Pins and Bushings should be positioned equally against the center of the fixture plate.
- For Port Style Pins, use with air joint that is available commercially.

Note: The maximum loading weight is the entire sum of the weight of fixture plates, fixtures and workpieces.

Note: The maximum loading weight shown is the value when two sets each of **AMWF-L-S** Pins and **AMWF-BU** Bushings are used.

AMWFH-WP

PNEUMATIC CLAMPING MODULES

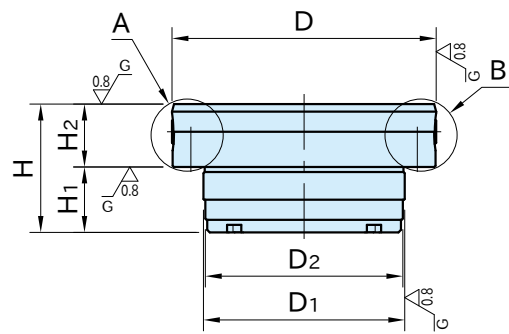
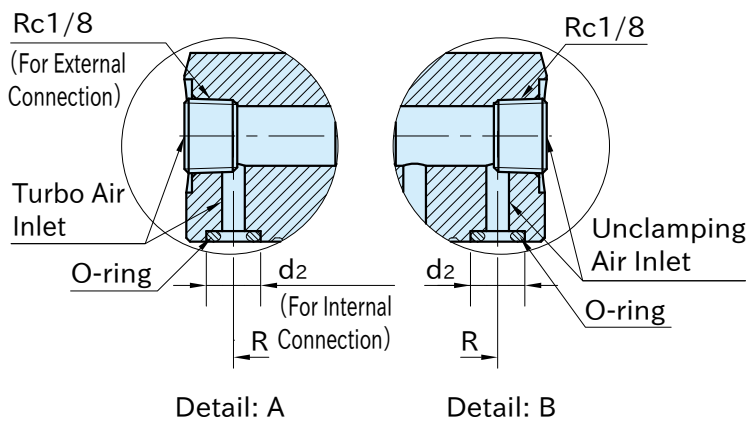
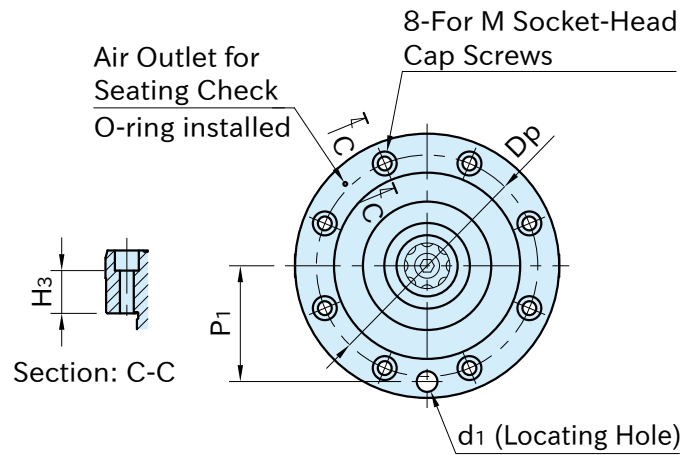

★Key Point

Single-acting clamping module.
Work as quick change & form holding system.

Body	Ball	Spring
S55C steel Black oxide finish HRC50-60	SUS440C stainless steel	Equivalent to SWOSC-V steel

Part Number	D (h7)	D ₁ (h6)	D ₂	H	H ₁	H ₂ (±0.005)	M	H ₃	D _p	P ₁ (±0.02)	R	d ₁ (G6)	d ₂	O-ring
AMWFH105-WP	105	80	79.5	51	26	25	M5	17	88	46	46	8	7.2	P4
AMWFH140-WP	140	110	109.5	65	33	32	M6	23	120	62	62	10	8.2	P5

Part Number	Clamping Force (kN)		Operating Air Pressure (MPa)	Weight (kg)
	w/o Turbo	w/ Turbo		
AMWFH105-WP	4	9-12	0.6-1.0	2.2
AMWFH140-WP	8.5	19-26		4.8

Note

- Do not plug the turbo port as it functions as an air vent even when not using turbo function. Mounting a filter prevents contamination.
- If seating confirmation by monitoring air flow is required, internal air supply must be provided. The detection switch and related components should be prepared by the customer.
- Use clean air by removing moisture and debris with an air dryer and air filter.
- Impurities in the compressed air can cause malfunction.

Supplied With

- AMWFH105-WP**: 1 of diamond pin BJ722-08001
- AMWFH140-WP**: 1 of diamond pin BJ722-10001
- 1 of locating pin
- 1 of orifice plug
- 8 of plastic mounting hole caps
- 1 of plastic locating hole cap

Feature

■ Clamping Mechanism

- This module clamps the plate with spring force, and can be boosted by supplying air to the turbo port. Supplying air to the unclamping port opens the module, and releasing air allows the spring to hold the clamping pin for clamping.
- Available with either external threaded connection or internal connection.

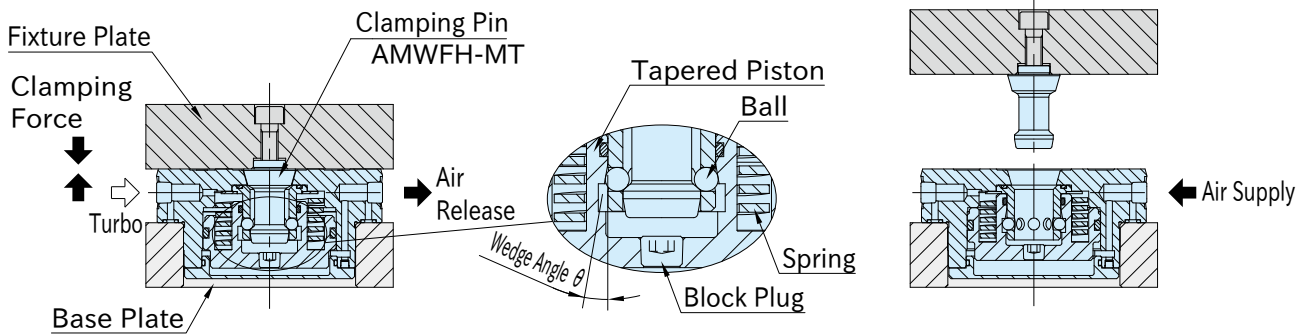

Releasing air allows the spring to push the tapered piston downward, which presses the balls and retracts the clamping pin. The clamping force can be boosted by supplying air to the turbo port.

Supplying air raises the tapered piston, releasing the pressure on the balls and unclamping the clamping pin.

- Precise dual contact provides excellent locating repeatability at 5 μ m.

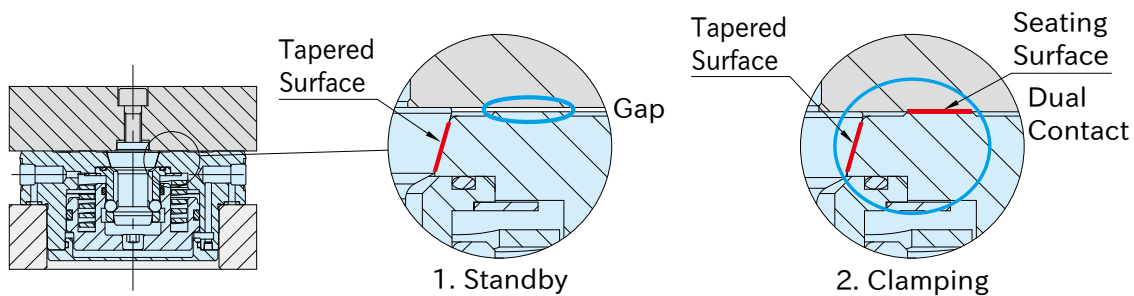

- Use the furnished diamond pin and the locating pin for single module applications.

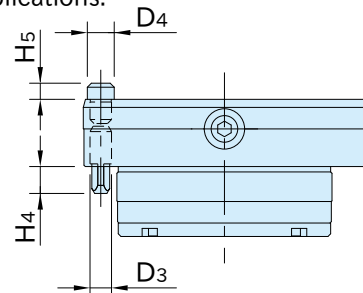
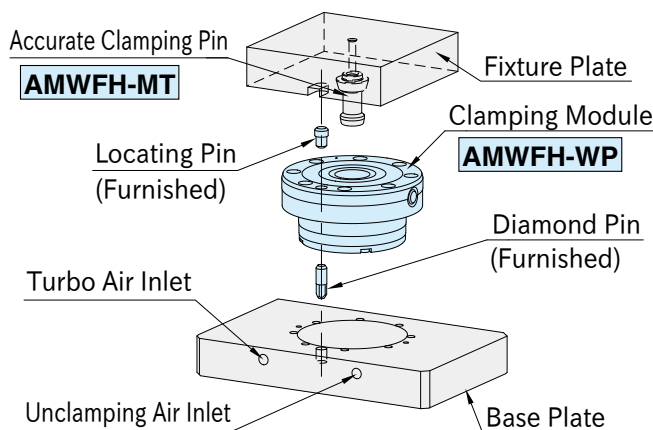

Part Number	D ₃ (h6)	H ₄	D ₄ (h6)	H ₅
AMWFH105-WP	8	10	10	6
AMWFH140-WP	10	12	12	7

- This module works as a form holding clamp for O.D. clamping or I.D. clamping by mounting optional jaws.

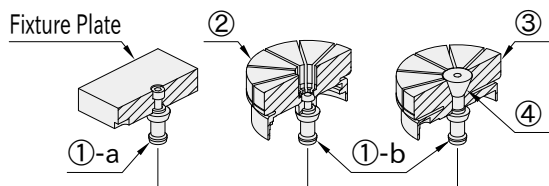

- ① Clamping Pin
 ①-a : AMWFH-MT
 ①-b : AMWFH-MS
- ② Jaw
 (External Holding) AMWFH-O
- ③ Jaw
 (Internal Holding) AMWFH-I
- ④ Tapered Screw
 (Internal Holding) AMWFH-IB

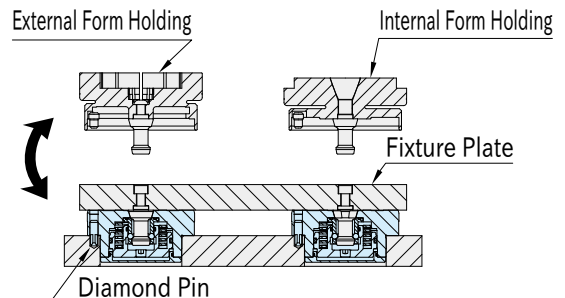

Diamond pins are not required for rotational positioning when using multiple modules. If the modules are also used for O.D. clamping or I.D. clamping, install diamond pins beforehand.

Continuing on Next Page

Blow-out Function

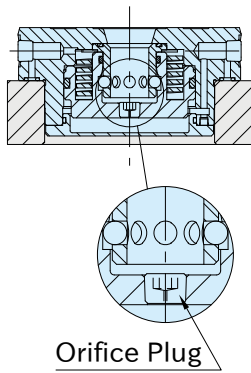

Orifice Plug

Replace the installed plug with the supplied orifice plug to enable air blow at the clamp pin insertion hole.

Mounting Hole Cap

Keep the top surface of the module clean by inserting the plastic cap into the mounting hole.

Installation

Tap in with plastic hammer

Mounting Hole Cap (Furnished)

Soft Metal Piece

Socket-Head Cap Screw

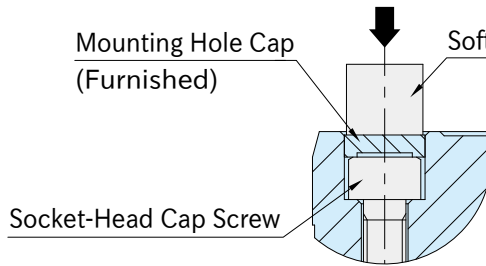

Removal

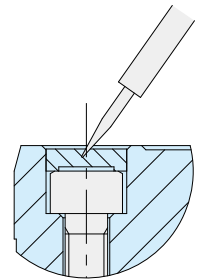

Place the mounting hole cap over the socket-head cap screw hole and tap it in using a plastic hammer.

When tapping, always place a piece of soft metal between the hammer and the plastic cap.

Insert a pointed tool into the cap to remove it.

Technical Information

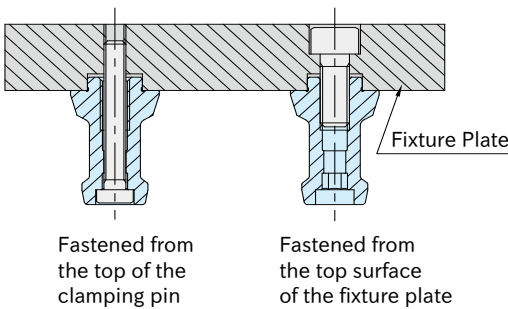

Fastened from the top of the clamping pin

Fastened from the top surface of the fixture plate

Clamping Modules	Clamping Pin Size	Holding Force (kN)*	
		Fastened From the Clamping Pin Top (Class 8.8 Screw)	Fastened From the Fixture Plate Top (Class 12.9 Screw)
AMWFH105-WP	AMWFH105-M8	17	21
AMWFH140-WP	AMWFH140-M12	47	100
	AMWFH140-M16	74	140

*) Exceeding the holding force will result in product or screw failure. This value does not include a safety factor. Measured at 0.6 MPa.

How To Use

Mounting Hole Dimensions

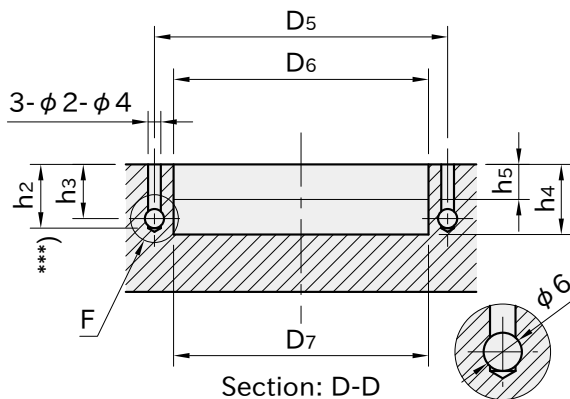
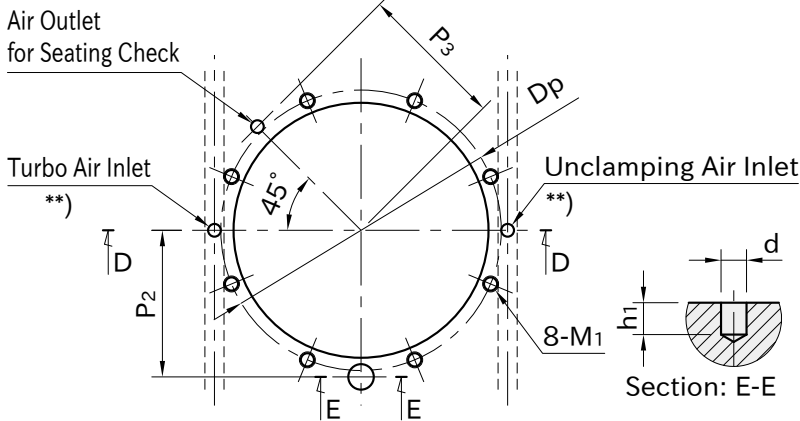

Detail: F

Machining Accuracy

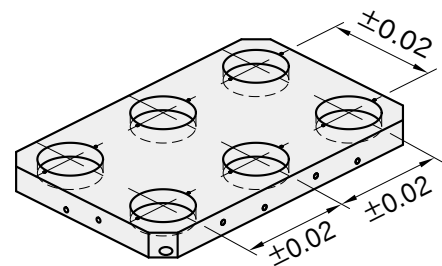

Spacing tolerance between mounting holes should be ± 0.02 .

Part Number	P ₂ (± 0.02)	P ₃	D _p	M ₁
AMWFH105-WP	46	46	88	M5×0.8 Depth 10 (Hole Depth 14)
AMWFH140-WP	62	62	120	M6×1.0 Depth 13 (Hole Depth 18)

Part Number	d (G7)	h ₁	D ₅	D ₆ (H7)	D ₇	h ₄	h ₅
AMWFH105-WP	8	10	92	80	79.8	27	14
AMWFH140-WP	10	12	124	110	109.8	34	19

***) Not required for external connection with Rc1/8 ports.

***) Refer to Internal Pneumatic Connection for the details of h₂ and h₃.

How To Use

Internal Pneumatic Connection

Prepare channel holes for turbo, unclamping, and (if needed) seating check in the base plate. Each channel should connect to a vertical hole with a diameter of $\phi 2-4$.

1. Actuating Two Modules

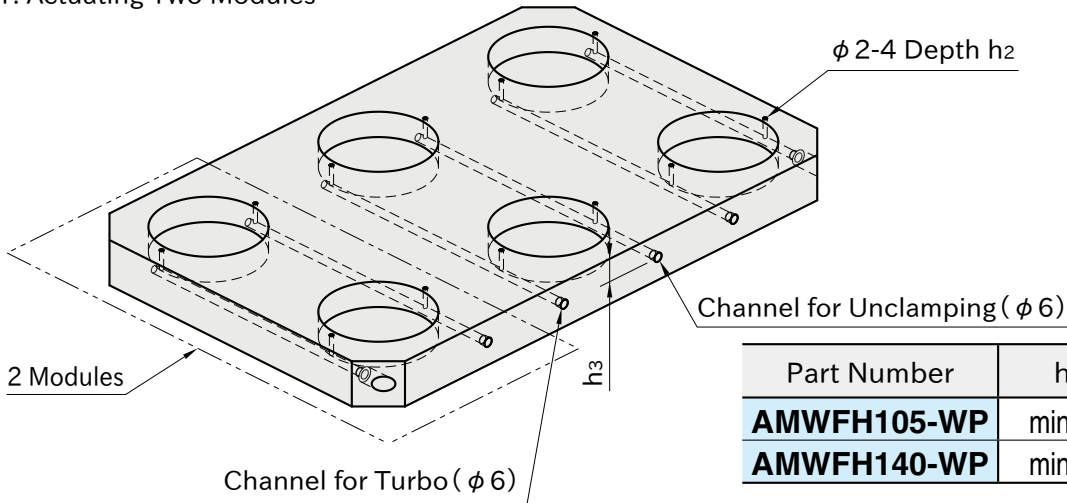

Part Number	h_2	h_3
AMWFH105-WP	min.21	min.18
AMWFH140-WP	min.23	min.20

Note: The depth is set as the minimum to avoid interference with the M_1 tapped holes. Make sure the channel is placed at this depth or deeper.

The depth of vertical holes ($\phi 2-4$) should be h_2 .

2. Actuating Multiple Modules

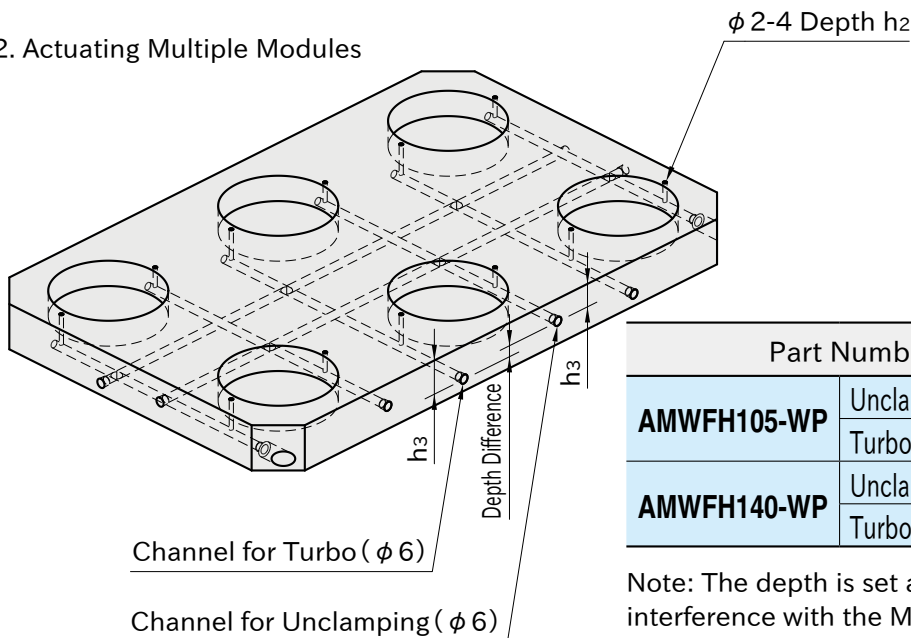

Part Number		h_2	h_3
AMWFH105-WP	Unclamping Channel	min.21	min.18
	Turbo Channel	min.31	min.28
AMWFH140-WP	Unclamping Channel	min.23	min.20
	Turbo Channel	min.33	min.30

Note: The depth is set as the minimum to avoid interference with the M_1 tapped holes. Make sure the channel is placed at this depth or deeper. The hole depths for the unclamping and turbo sides can be reversed if needed.

- The depth of vertical holes ($\phi 2-4$) should be h_2 .
- Make sure to set different depths for the turbo and unclamping channels to avoid interference.
- Use one air supply port each for turbo and unclamping, and plug the unused ports. Screw plugs should be prepared by the customer.

Related Products

- [AMWFH-M](#) CLAMPING PINS
- [BJ722](#) DIAMOND LOCATING PINS
- [AMWFH-O](#) JAWS FOR EXTERNAL FORM HOLDING
- [AMWFH-I](#) JAWS FOR INTERNAL FORM HOLDING

AMWFH-M

CLAMPING PINS

標準在庫品 



(Locating, Round) (Locating, Diamond) (Clamping)

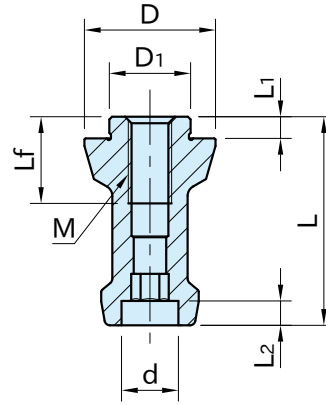

Body
SCM415 Steel
Carburized-hardened
Black oxide finished

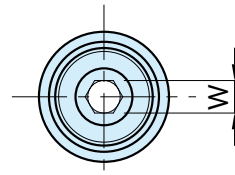

AMWFH-MT
(Round)

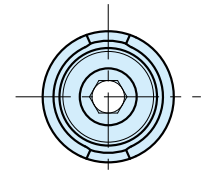

AMWFH-MD
(Diamond)

Part Number	Type	M	D ₁	L ₁	D	L	d	L ₂	W	L _f	Weight (g)	Pneumatic Clamping Modules
AMWFH105-M 8T	Round	M 8×1.25	15g6	4	24.2	38.5	10.5	4.5	6	16	55	AMWFH105-WP
AMWFH105-M 8D	Diamond		15 ^{-0.1}		24							
AMWFH105-M 8S	Clamping											
AMWFH140-M12T	Round	M12×1.75	25g6	5	34.2	51.5	16.5	6.5	10	24	170	AMWFH140-WP
AMWFH140-M12D	Diamond		25 ^{-0.1}		34							
AMWFH140-M12S	Clamping											
AMWFH140-M16T	Round	M16×2	25g6	5	34.2	51.5	18.5	7.5	12	30	140	AMWFH140-WP
AMWFH140-M16D	Diamond		25 ^{-0.1}		34							
AMWFH140-M16S	Clamping											

How To Use

■ Use of Single Pin

Type T Round Pin: 1 pc

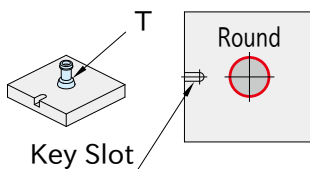

■ Use of 2 Pins

Type T Round Pin: 1 pc
Type D Diamond Pin: 1 pc

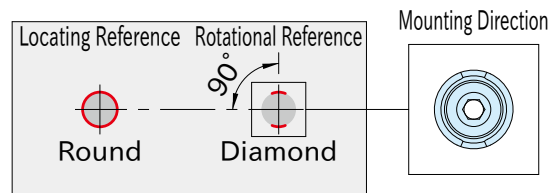
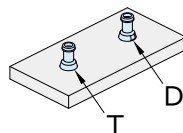

■ Use of 4 or More Pins

Type T Round Pin: 1 pc
Type D Diamond Pin: 1 pc
Type S Non-Locating Clamping Pin: 2 pcs or more

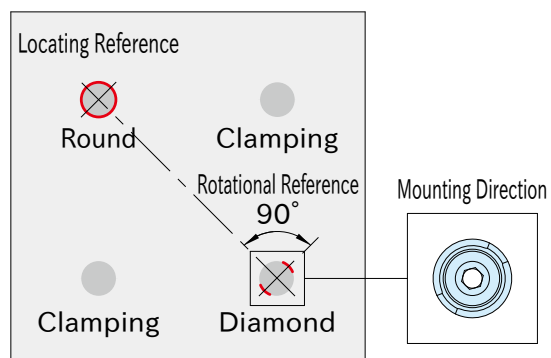
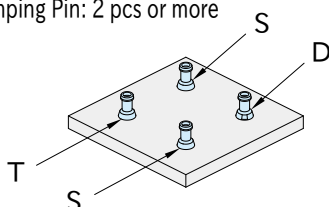

How To Use

■ Mounting Hole Dimension

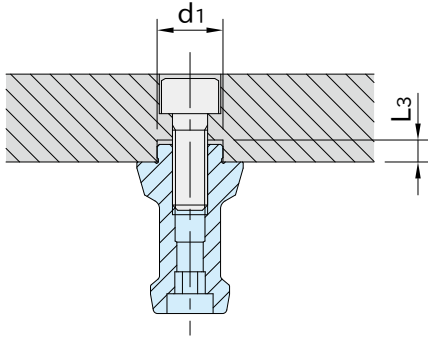

Size	d ₁ (H7)	L ₃
AMWFH105-M8	15	4.5
AMWFH140-M12	25	5.5
AMWFH140-M16		

Note: The tolerance of d₁ for Type S non-locating Clamping Pin is $^{+0.1}_0$.

■ Spacing Tolerance

Should be ± 0.02 for Type T and D Locating Pins. The required tolerance for Type S non-locating Clamping Pin is ± 0.1 .

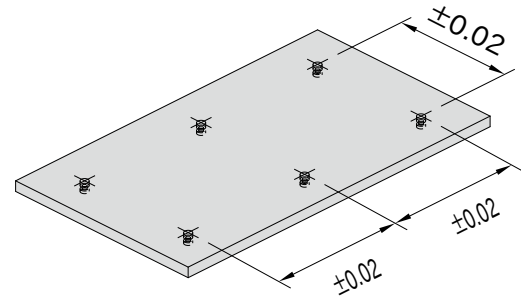

■ How To Install

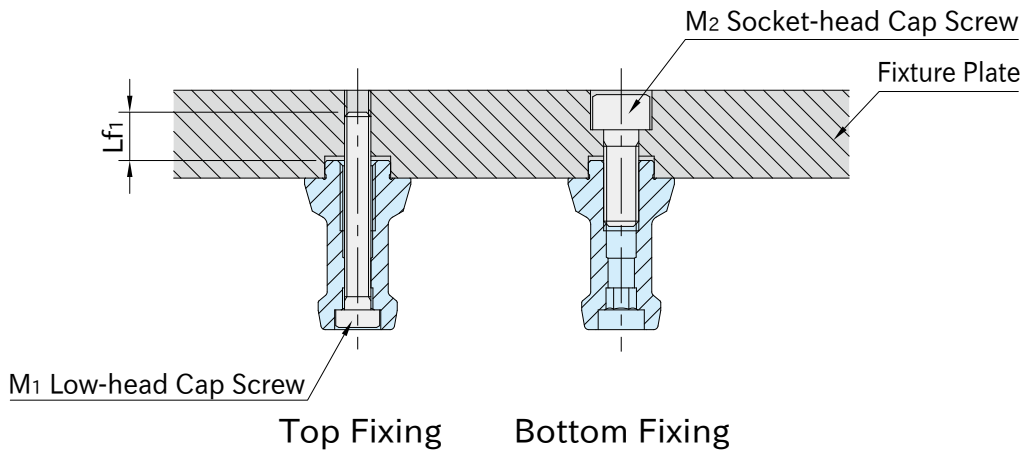

Size	M ₁	L _{f1}	M ₂
AMWFH105-M8	M 6×1 -45L	11	M 8
AMWFH140-M12	M10×1.5 -60L	15	M12
AMWFH140-M16	M12×1.75-60L	16	M16

The screws should be prepared by the customer.
The length of screw differs by the thickness of fixture plate.

AMWF-W

PNEUMATIC FLEX LOCATOR PINS



(Tapered Type)



(Straight Type)

Body	Cylinder	Ball
SCM440 steel Induction hardened Black oxide finished Precision ground	S45C steel Induction hardened Electroless nickel plated	SUS440C stainless steel

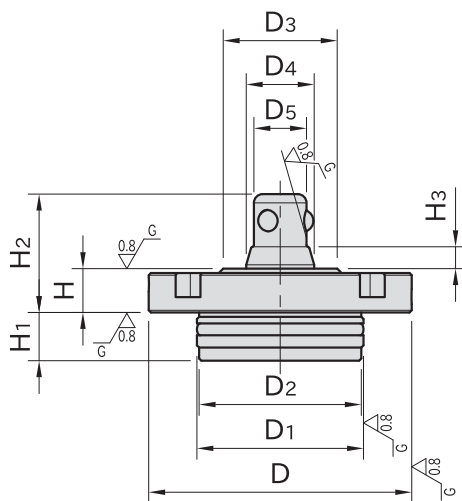
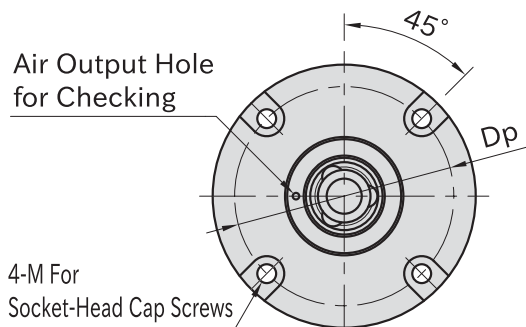

AMWF-W-T (Tapered Type)

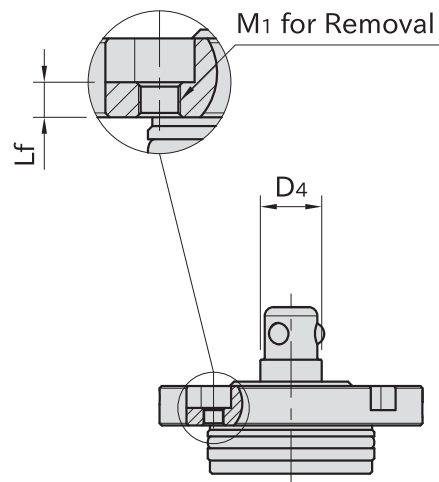

AMWF-W-S (Straight Type)

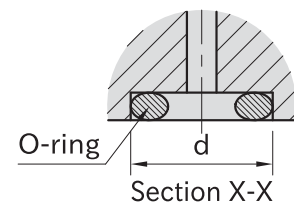
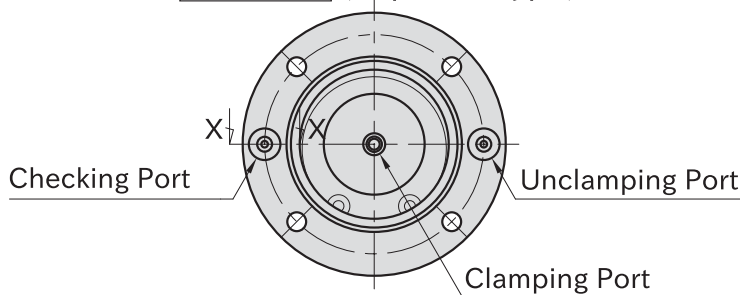

Reference

- How To Use PNEUMATIC FLEX LOCATORS
- How To Install PNEUMATIC FLEX LOCATORS

Note

- Use clean air by removing dust with filter or draining with dryer.
- Impure compressed air may cause malfunction of the products.
- Using lubricator is recommended.

Size		D ₁ (g6)	D ₂	H ₁	D	D ₃	H (±0.003)	M	H ₃	D ₅ (-0.05 -0.15)	H ₂	Lf	M ₁	Dp
AMWF-W-T	40	48	47.5	15	70	38	12	M5	8	16	35	5	M6×1 (Drilled Hole φ5.2)	60
AMWF-W-S	50	58	57.5	19	85	48	15	M6	10	20	44	6	M8×1.25(Drilled Hole φ6.8)	72

Size		d	Furnished O-ring	Operating Air Pressure(MPa)*	Clamping Force(kN)
AMWF-W-T	40	7.2	P4	0.5	4
AMWF-W-S	50	8.2	P5		6.3

Related Product
AMWF-BU PNEUMATIC FLEX LOCATOR
 BUSHINGS

*) At least 0.45 MPa is required for unclamping.
 The maximum operating air pressure is 1 MPa.

AMWF-W-T (Tapered Type)

Part Number	D ₄	Weight (g)
AMWF40-W-T	24.5	450
AMWF50-W-T	31.5	820

AMWF-W-S (Straight Type)

Part Number	D ₄	Weight (g)
AMWF40-W-S	20	440
AMWF50-W-S	26	810

Feature

■ Structure and Locating Mechanism

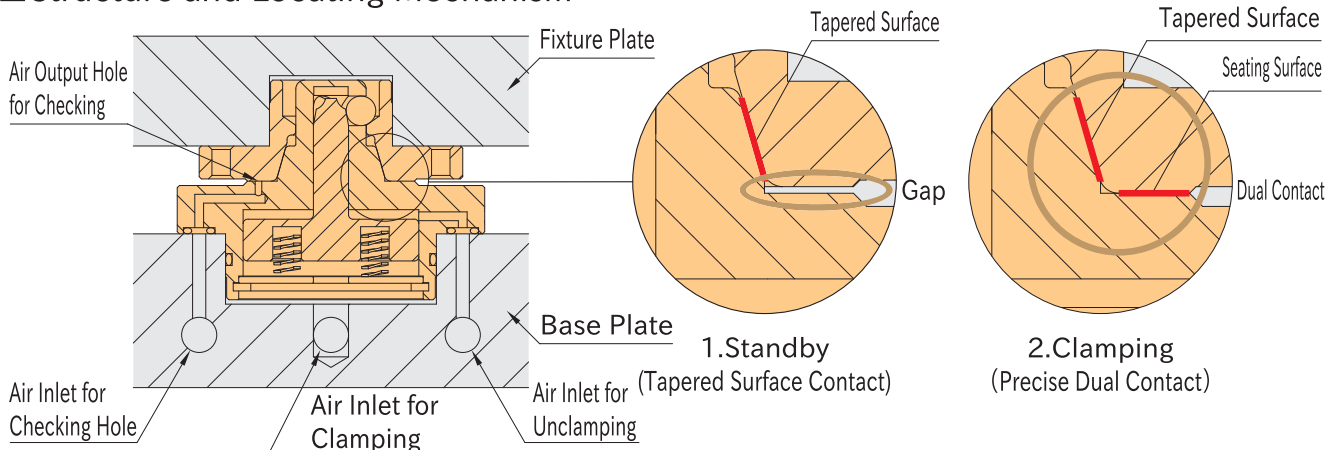

- When the air pressure is lowered by an air leakage, the wedge mechanism and the spring prevent prompt lowering of the clamping force.
 Clamping Force at 0 Mpa Air Pressure (Clamping Force of Spring)
 - AMWF40Type...1.2kN
 - AMWF50Type...1.8kN
- Can check if the fixture plate is clamped properly by applying air through the checking hole.

- Precise dual contact provides excellent locating repeatability at 3 μm.

■ Functions

Locating with Tapered Type

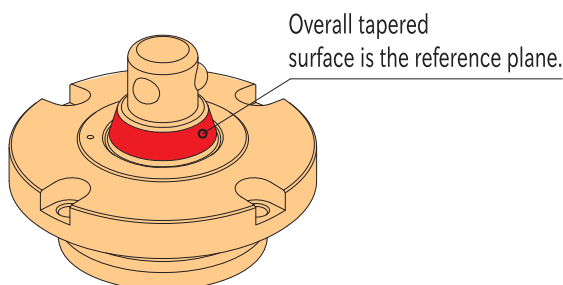

Clamping with Straight Type

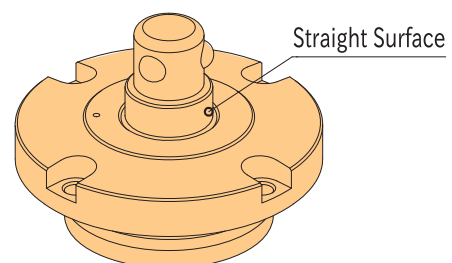

AMWF-BU

PNEUMATIC FLEX LOCATOR BUSHINGS



(Tapered Type)



(Diamond Type)



(Straight Type)

Body
SCM440 steel
Quenched & tempered
Black oxide finish
Precision ground

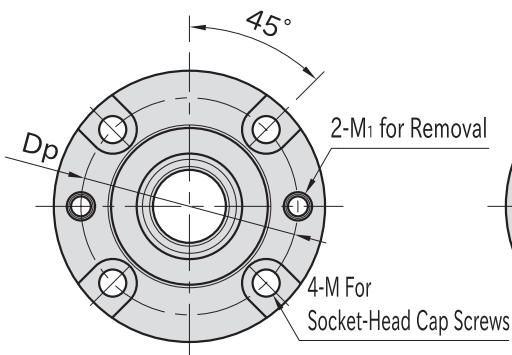
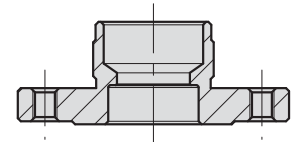
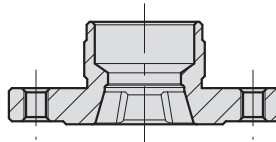
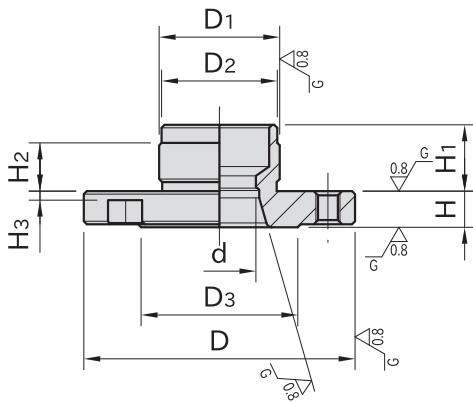

AMWF-BU-T
(Tapered Type)

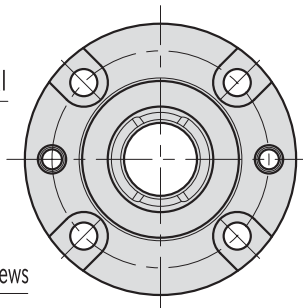

AMWF-BU-D
(Diamond Type)

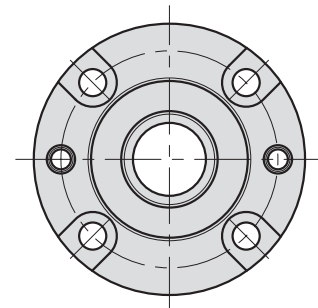

AMWF-BU-S
(Straight Type)

Size	D ₁ (g6)	H ₂	D ₂	H ₁	M	H ₃	D	D ₃	H (±0.003)	d (^{+0.15} / _{+0.05})	M ₁	D _p
AMWF-BU-T	40	28	10	27.5	15	M5	2.5	60	8	16	M5×0.8	50
AMWF-BU-D												
AMWF-BU-S	50	36	14	35.5	19	M6	3.5	75	10	20	M6×1	62

AMWF-BU-T (Tapered Type)

Part Number	Weight (g)
AMWF40-BU-T	160
AMWF50-BU-T	323

AMWF-BU-D (Diamond Type)

Part Number	Weight (g)
AMWF40-BU-D	159
AMWF50-BU-D	322

AMWF-BU-S (Straight Type)

Part Number	Weight (g)
AMWF40-BU-S	163
AMWF50-BU-S	330

Feature■ **Function**

Locating with Tapered Type
For setting reference position

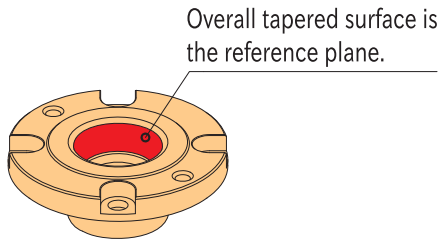

Locating with Diamond Type
For locating reference at rotational direction

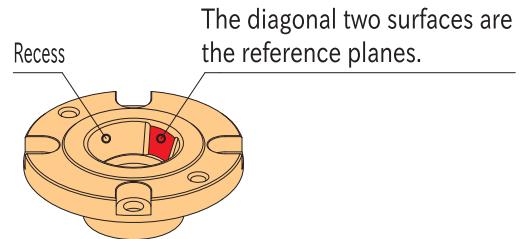

Clamping with Straight Type

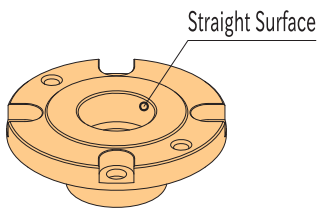
**Related Product**

AMWF-W PNEUMATIC FLEX LOCATOR PINS

Reference

- How To Use PNEUMATIC FLEX LOCATORS
- How To Install PNEUMATIC FLEX LOCATORS

How To Install PNEUMATIC FLEX LOCATORS

■ Mounting Hole Dimensions for Pins

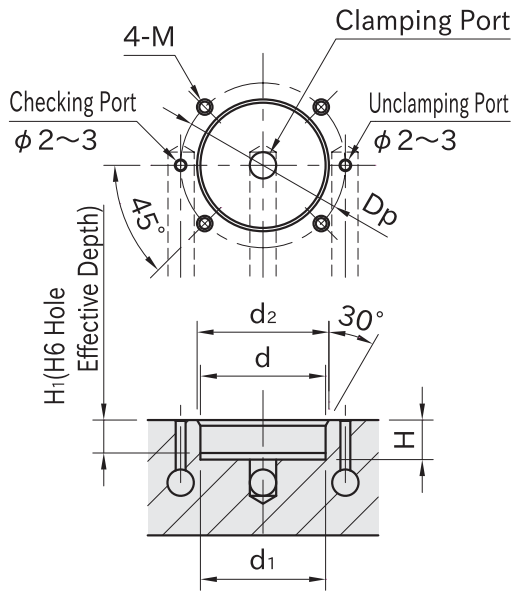

Size	d (H6)	H1	d1 (-0.1/-0.3)	H	d2	M	Dp
AMWF40-W	48	12	48	16	50	M5×0.8	60
AMWF50-W	58	16	58	20	60	M6×1	72

■ Mounting Hole Dimensions for Bushings

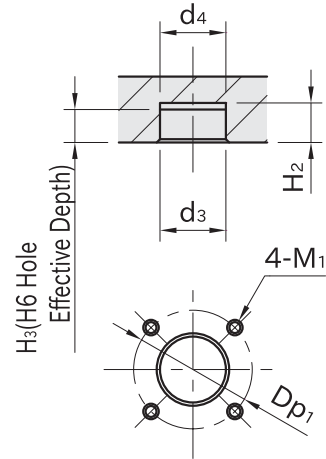

Size	d3 (H6)	H3	d4 (-0.1/-0.3)	H2	M1	Dp1
AMWF40-BU	28	12	28	16	M5×0.8	50
AMWF50-BU	36	16	36	20	M6×1	62

■ Spacing Tolerance

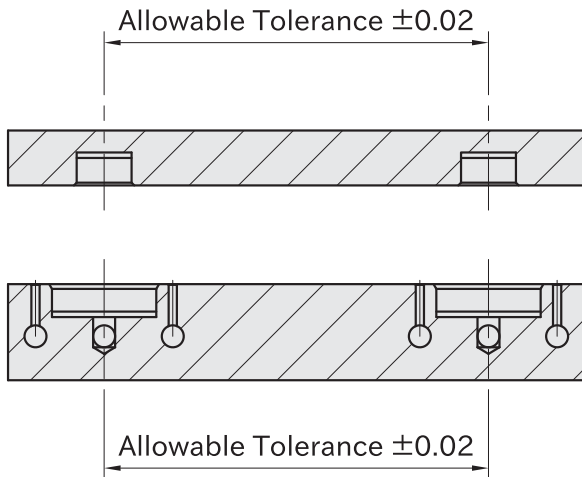

■ How to Remove Pins

For easier removal, insert screws into the tapped holes and screw them.

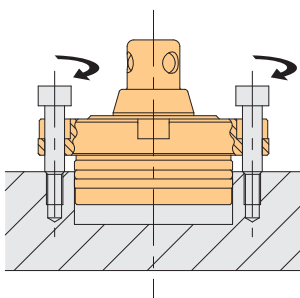

■ How to Remove Bushings

For easier removal, insert screws into the tapped holes and screw them.

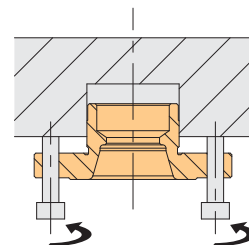

How To Use PNEUMATIC FLEX LOCATORS

Application Example

For clamping at 2 points

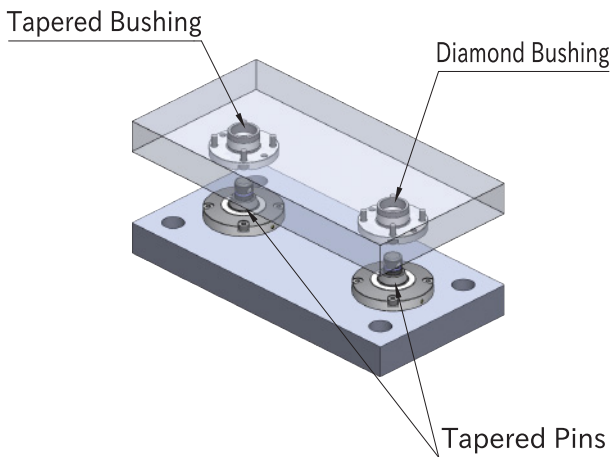

For clamping at 4 points

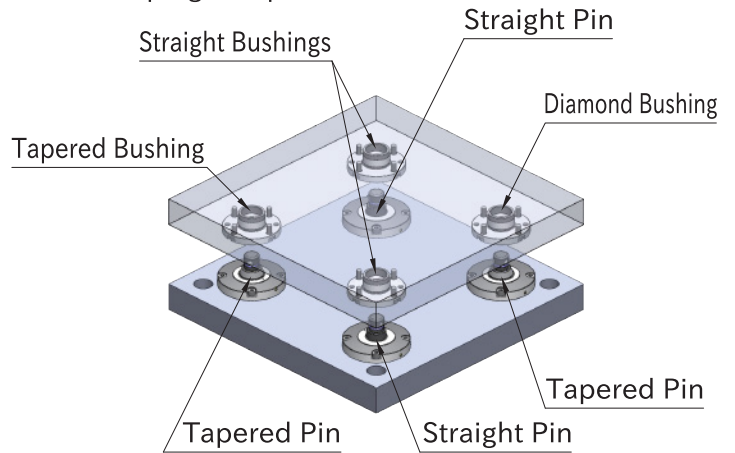

Positioning Order of Bushings

Mount the Tapered Bushings and Diamond Bushings as in the figure below for locating fixture plates. Pay attention to the mounting direction of the Diamond Bushings, since the direction for use at 2 points and the direction for use at 4 points differ.

For clamping at 2 points

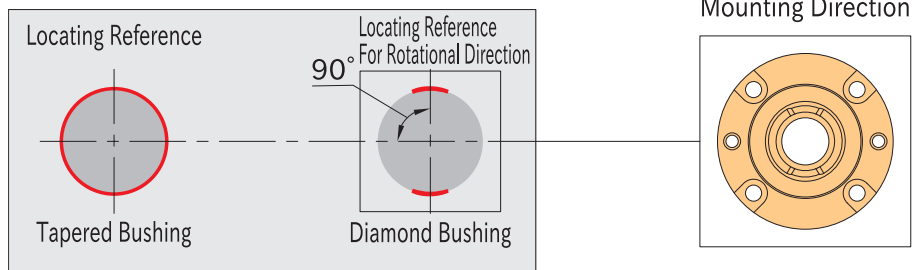

For clamping at 4 points

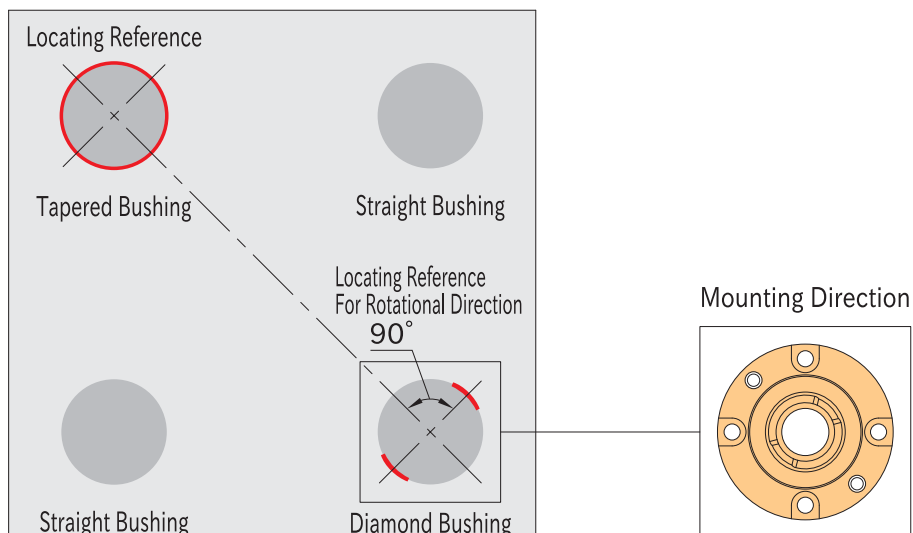



33792 Doreka Dr. Fraser, MI 48026

586-294-1188

cs@fixtureworks.com